



Rhif y Cais / Application Number :

C13/0611/18/AM

Cynllun lleoliad ar gyfer adnabod y safle yn unig. Dim i raddfa.  
Location Plan for identification purposes only. Not to scale.



Atgynhyrchir y map hwn o Ddeunydd yr Ordnance Survey gyda chaniatâd yr Ordnance Survey ar ran Rheolwr Llyfrfa Ei Mawrhydi.  
© Hawlfraint y Goron.  
Mae atgynhyrchu heb ganiatâd yn torri hawlfraint y Goron a gall hyn arwain at erlyniad neu achos sifil.  
Cyngor Gwynedd - 100023387 - 2006

This map is reproduced from Ordnance Survey material with the permission of Ordnance Survey on behalf of the Controller of Her Majesty's Stationery Office  
© Crown copyright.  
Unauthorised reproduction infringes Crown copyright and may lead to prosecution or civil proceedings.  
Cyngor Gwynedd - 100023387 - 2006

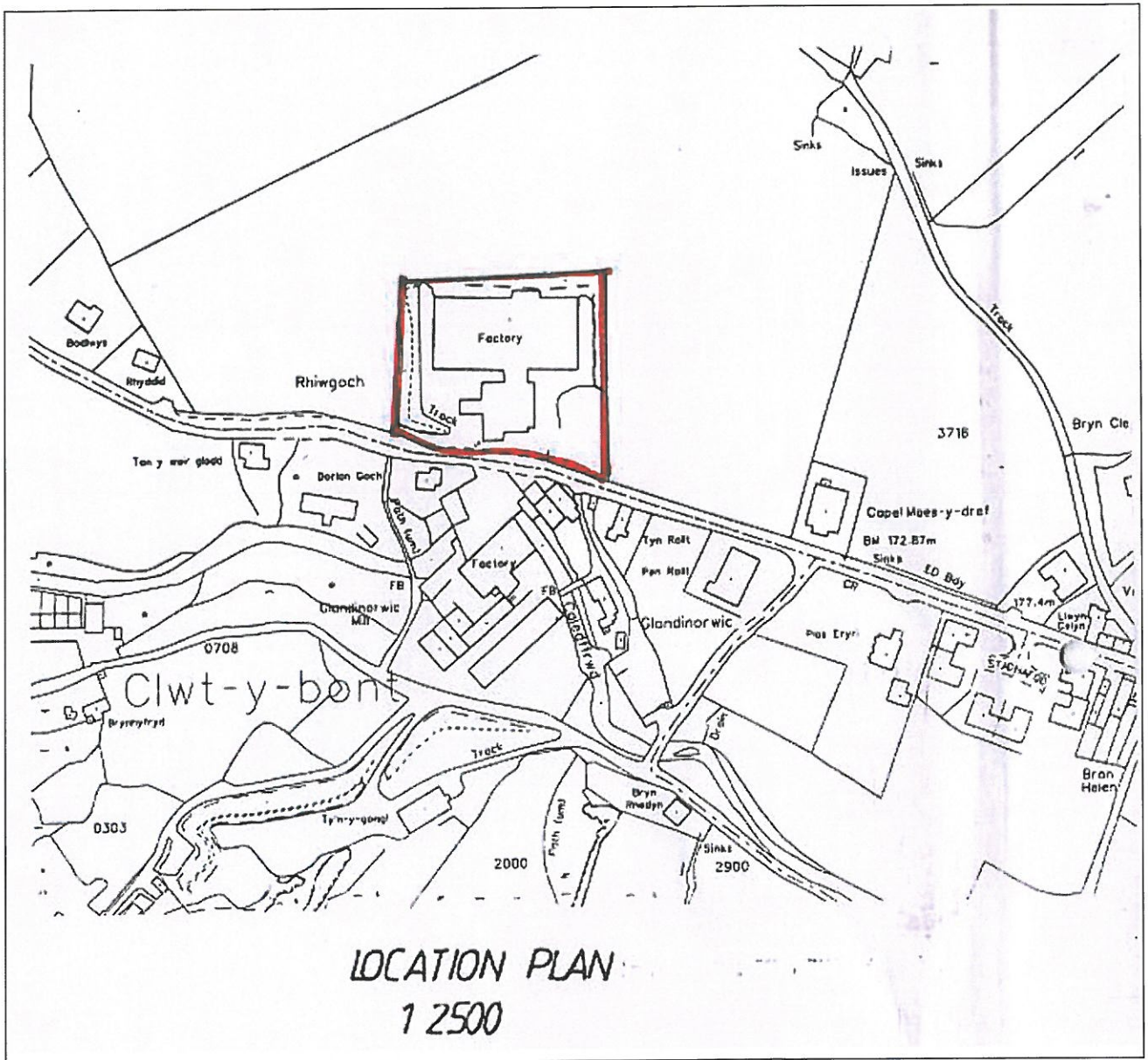

Proposed New Dwellings on  
Land at:  
Rhiw Goch, Clwt Y Bont,  
Deiniolen, Caernarfon,  
Gwynedd. LL55 3DE

Rhiwgoch

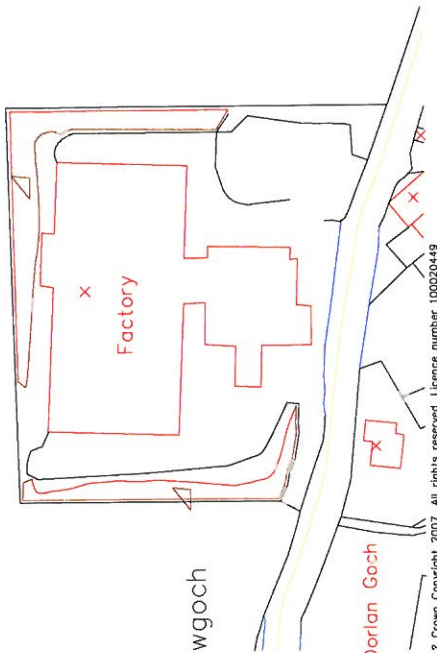

Dorlan Goch

? Crown Copyright 2007. All rights reserved. Licence number 10002049

Rhiwgoch

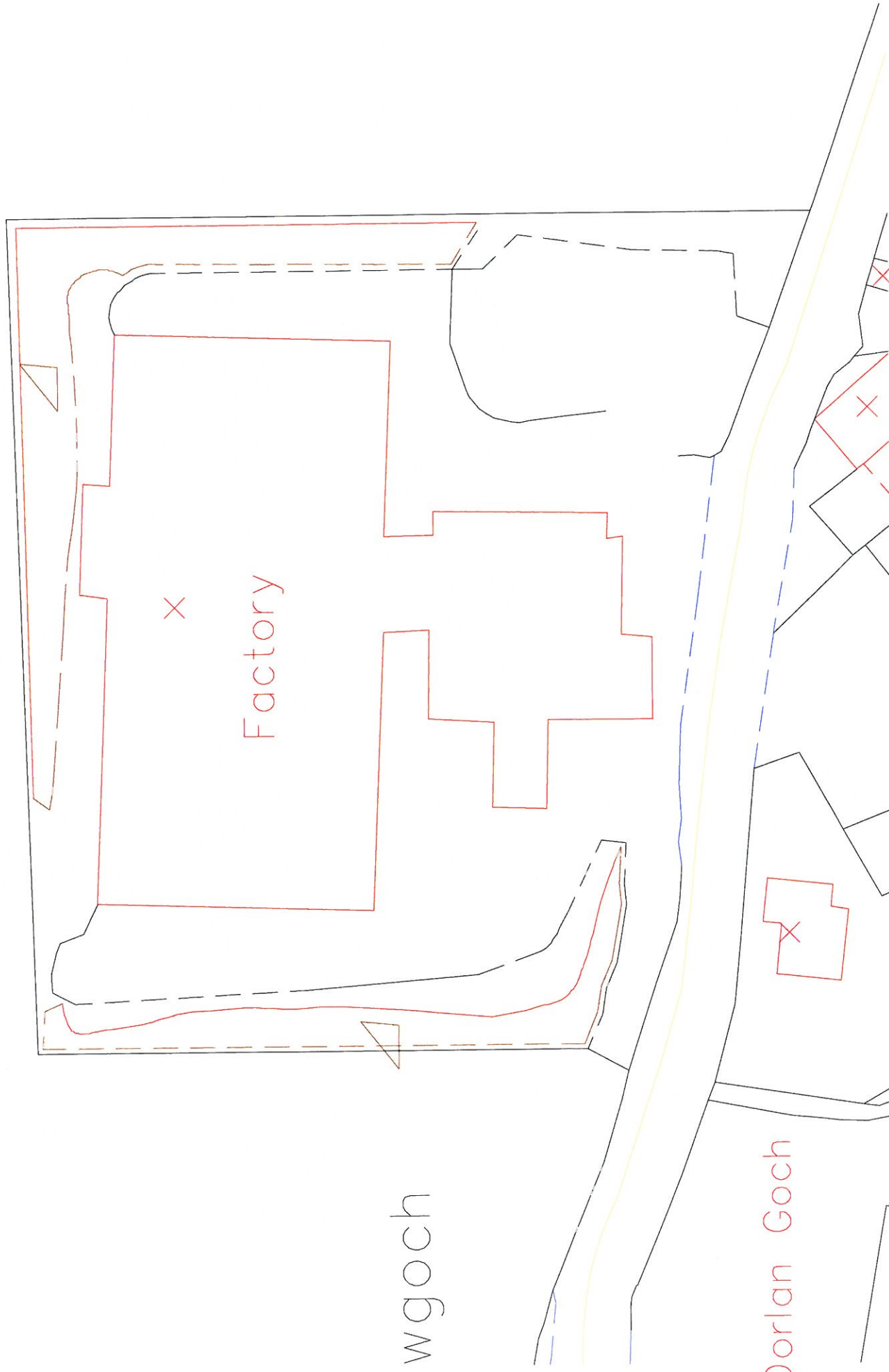

Dorlan Goch

**CYNLLUN DIWYGIEDIG  
REVISED PLAN**

Derbyn/Received 11.06.14

Llofnod/Signature

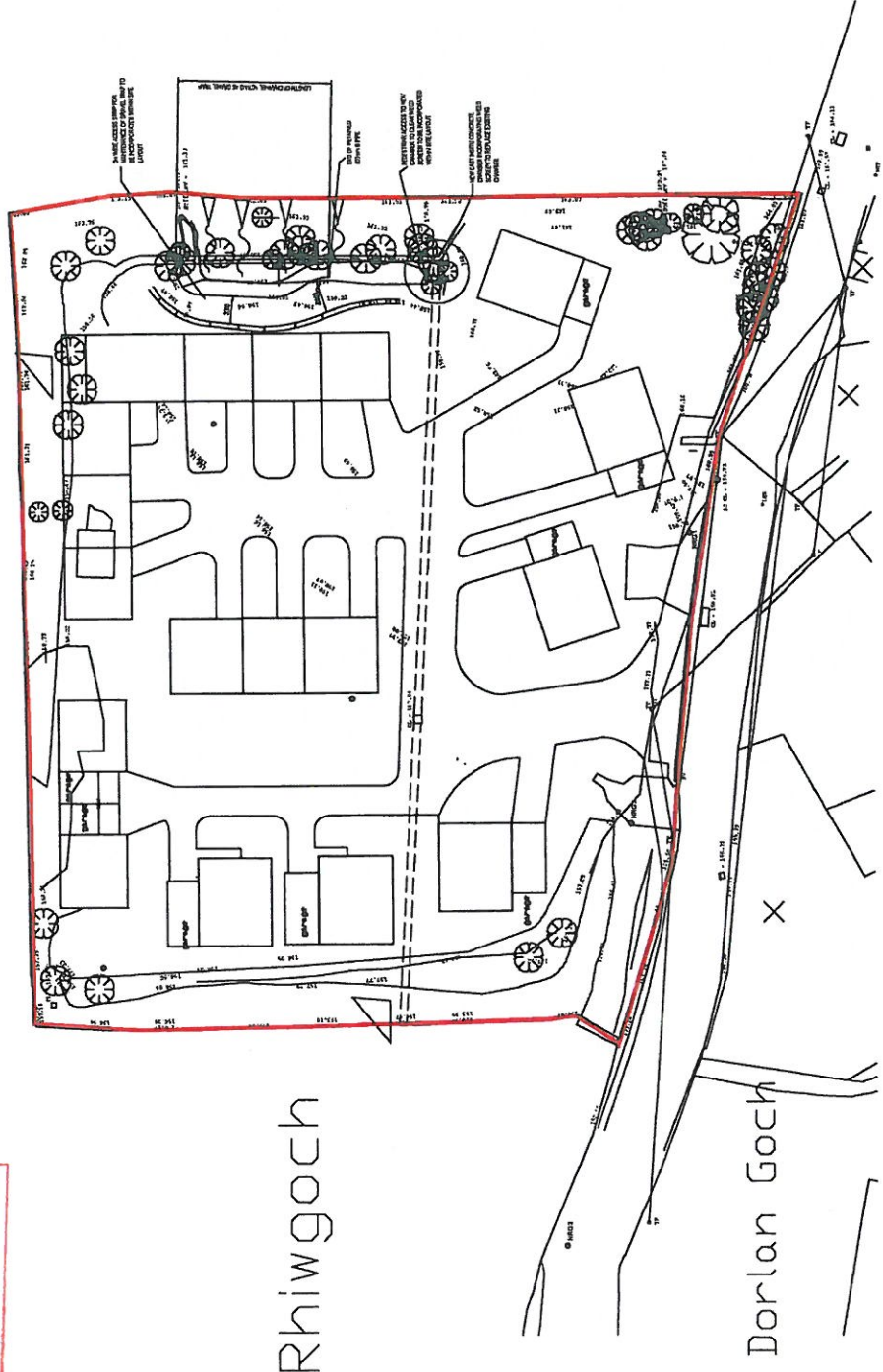

Rhiwgoch

Dorlan Goch

Schmact:

RHIW GOCH FCA

Tiâl:

Dat:

Scale: 1:500 A3

Drawing no. 004 - V4