

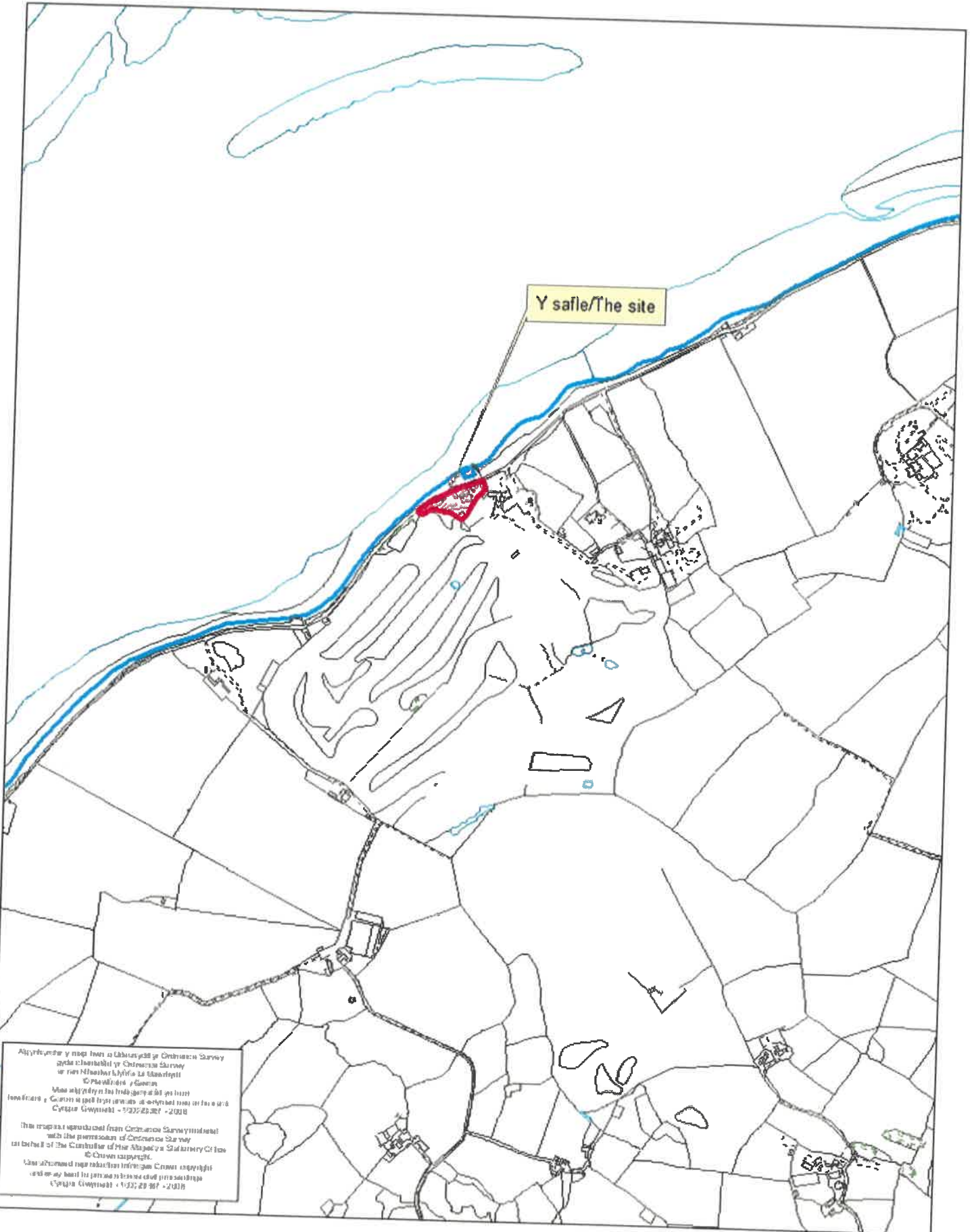

Rhif y Cais / Application Number : C16/1412/19/LL

Cynllun lleoliad ar gyfer adnabod y safle yn unig. Dim i raddfa.
Location Plan for identification purposes only. Not to scale.



Apwyntwyd y map hon o Ddwytydd yr Ordnance Survey
gyda chwestiwn yr Ordnance Survey
ar rai Nhasur, Llybia La Mawrffell
© Pwllin y Gaeon
Mae hysbysu'r hysbysu ar ôl yr hysbys
llofnodi y Cynllun Gwynedd Cofrestru a'r hysbysu
Cynllun Gwynedd - 1937/2019 - 2019

This map is reproduced from Ordnance Survey material
with the permission of Ordnance Survey
on behalf of the Controller of Her Majesty's Stationery Office
© Crown copyright
All other material reproduced here is the copyright
of the Controller of Her Majesty's Stationery Office
Cynllun Gwynedd - 1937/2019 - 2019

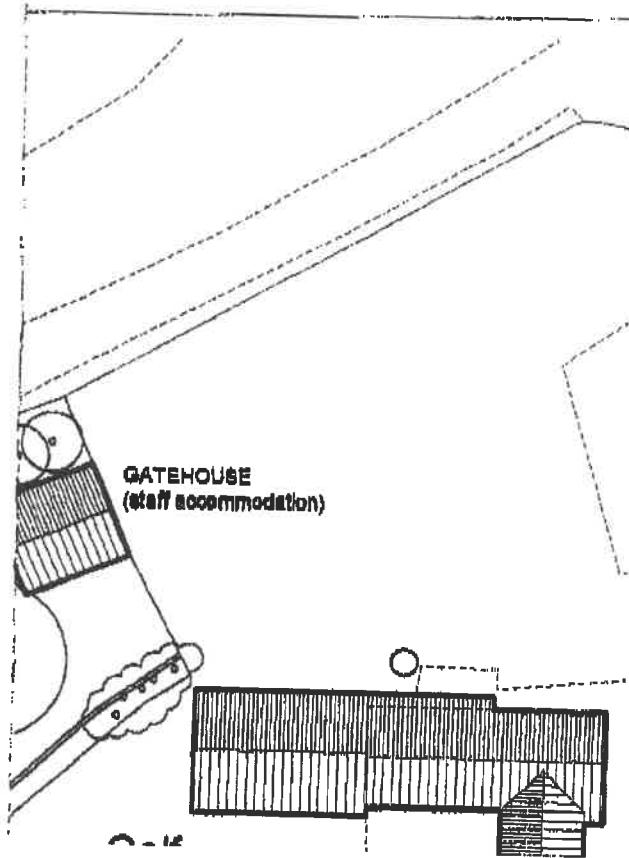

GATEHOUSE
(staff accommodation)

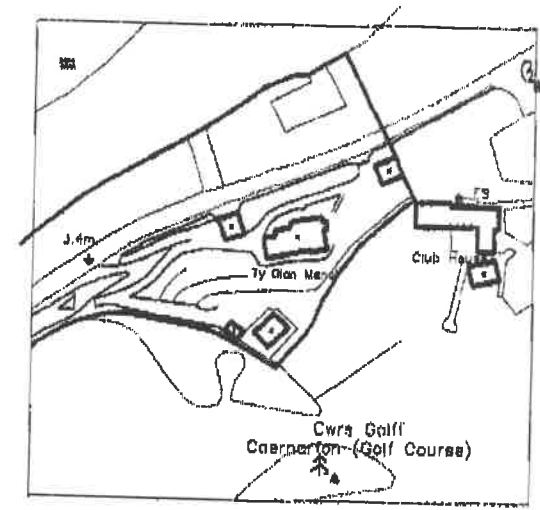

LOCATION PLAN scale 1:2500

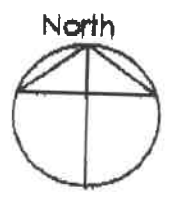

Rev B 03/04/09 trees

Rev B 02/12/08 minor amendments

SEPTIC (PACKAGE TREATMENT) TANK CALCULATIONS

Based on 12no. Hotel Bedrooms on 24no. Guests and allowance of 6no. People for Staff and Visitors, please see below in line with BS6207:
 C = 150 (P = 2,000)
 C is the size of the septic tank in litres.
 P is the population to be served - this is potential not actual inhabitants.
 Therefore the maximum occupancy 30 = 2000 litres + 4500 (150 x 30) = 6500 litres would be the minimum size tank required.
 Proposed tank to be Klugeberg (Biomat) (Biomat) Sewage Treatment Plant which is suitable for 30 people. Full details and specifications to be provided by way of the Planning Conditions.
 H1 - Septic tank to be located in the position of the original 100% brick chamber septic tanks in the existing driveway to the West of the site.

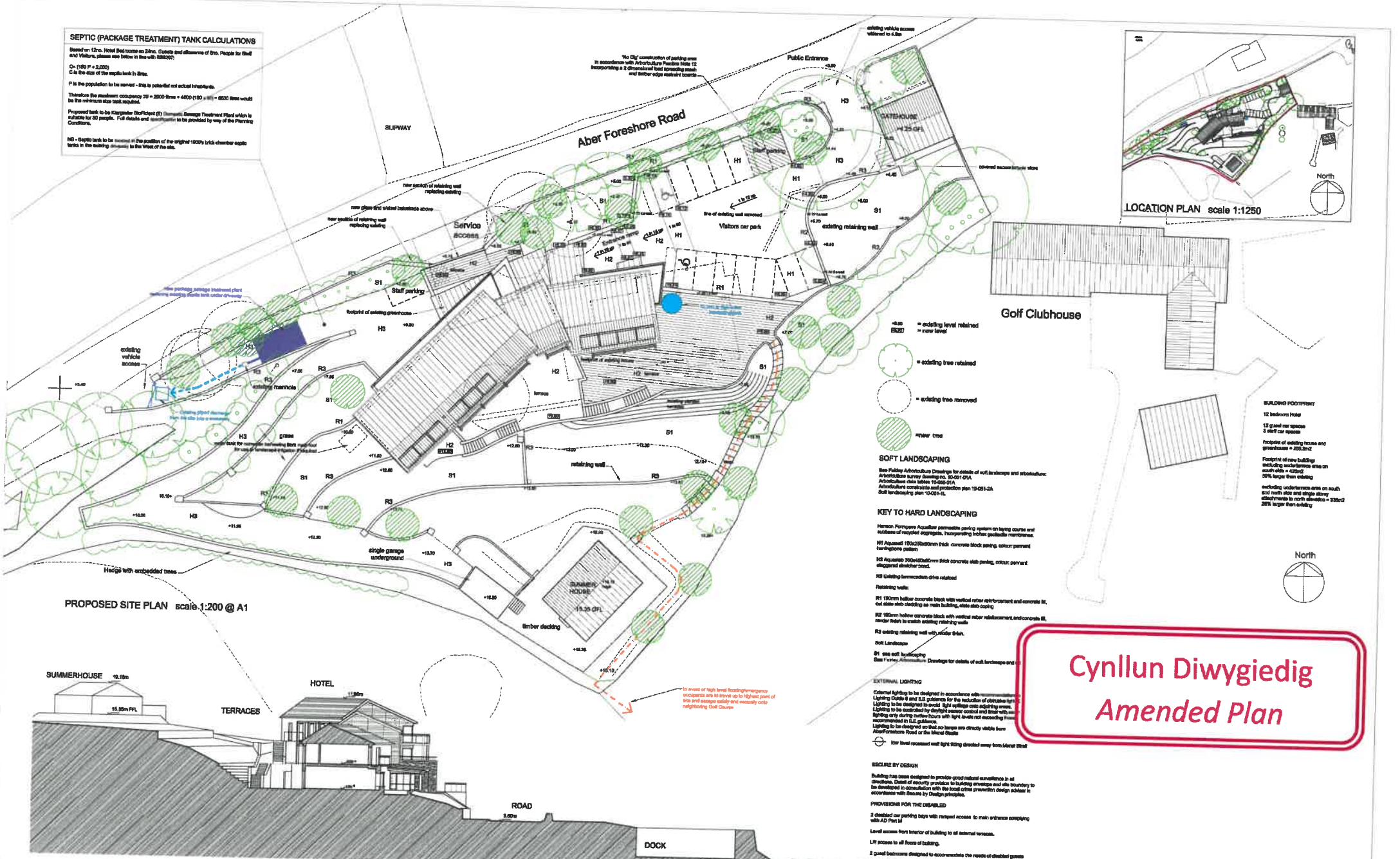
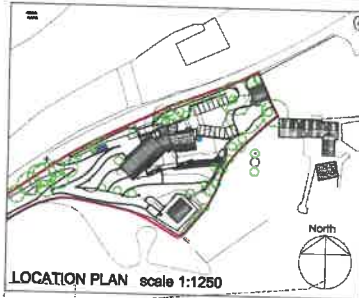

PROPOSED SITE PLAN scale 1:200 @ A1

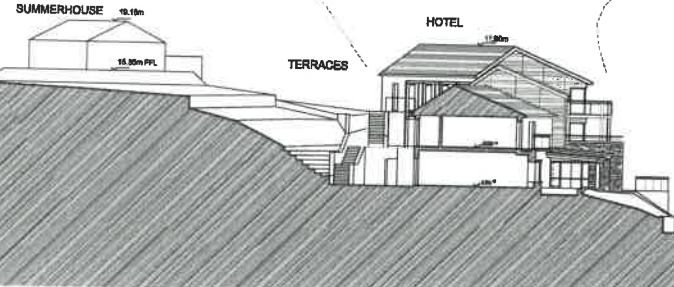

PROPOSED SITE SECTION scale 1:200 @ A1

**Cynllun Diwygiedig
Amended Plan**

All dimensions to be checked on site. Figured dimensions to be used in preference to scaled. RDP assumes the responsibility for any unauthorised amendments to the drawings and does not warrant the accuracy of the drawings. This drawing is copyright and remains the property of KDP unless otherwise agreed.

Revisions	Revisions	Revisions	Revisions
No	Date	Description	By
A	10.11.17	Pool omitted and emergency flood escape route added.	MD
B	17.06.18	Previously approved footpath and parking shown, and Septic Tank Calculations Added.	MD
C	24.05.18	Package treatment confirmed and off site plus location indicated shown.	MD
D	07.05.18	Downway location indicated shown.	MD
E	08.05.18	Downway location updated - Inductively shown.	MD

THE KEITH DAVIDSON PARTNERSHIP
 13 Seymour Terrace
 Brynmor Street
 Llanelli, SA41 1JG
 Telephone: +44 (0) 151 703 1777
 Fax: +44 (0) 151 703 5993
 Email: info@kdparchitects.com
 Website: www.kdparchitects.com

Client: Mick McKenna
Job Title: Ty Glan Menai Llanfaglan, Caernarfon
Drawing Title: Proposed Site Plan

PLANNING
 Ref: 102
 Date: 08/08/18

KDP
 ARCHITECTS



SOUTH ELEVATION
scale 1:100 @ A1

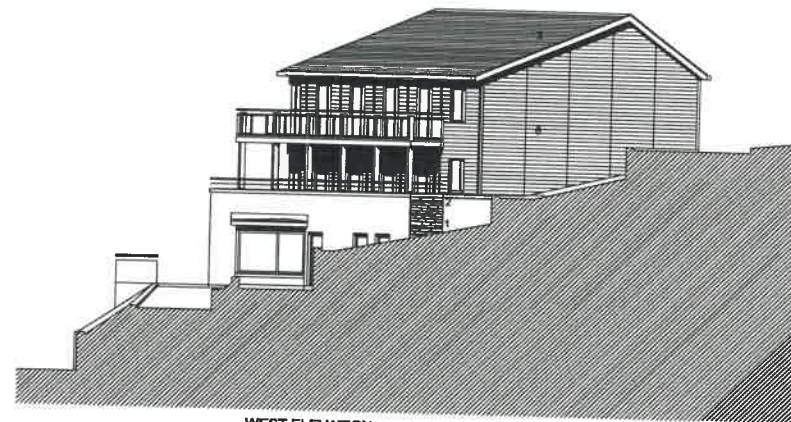

WEST ELEVATION
scale 1:100 @ A1

Cynllun Diwygiedig
Amended Plan

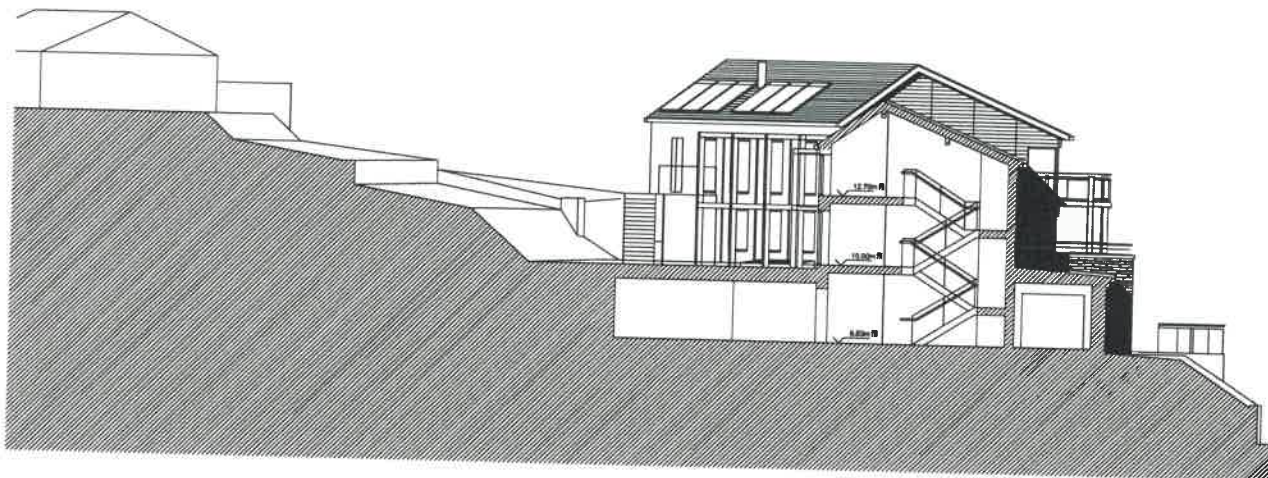

SECTION BB
scale 1:100 @ A1

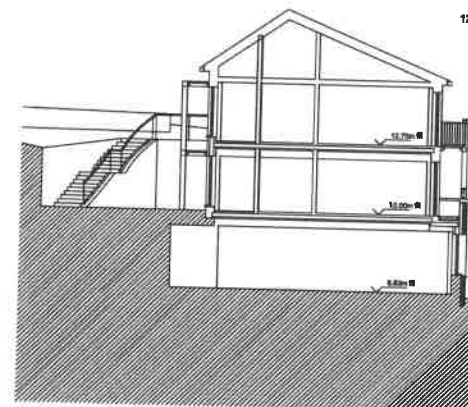

SECTION CC
scale 1:100 @ A1

MATERIALS

- 1 Penryn Heather Blue slate cut slab wall facing
- 2 Welsh slate coping
- 3 Natural Welsh slate roof finish
- 4 Timber roof eaves, verge and soffit cladding
- 5 Natural aluminium RW gutters and downpipes
- 6 Horizontal timber cladding
- 7 Windows and doors: ground floor, hardwood/acoya first and second floor, uPVC (triple glazing on north elevation)
- 8 Oak frame balcony structure
- 9 Oak, glass and stainless steel balustrade with HW handrail
- 10 Lead roof with rolled joints
- 11 Oak framed brise soleil
- 12 Evacuated tube solar collectors/PV panels (indicative, size and number of panels to be determined)

DAVID TYRER CPA ANCH RIBA
CHARTERED ARCHITECT

21 Brockleaze Buildings, Bath, BA1 6BA
Tel 01225 315868

Client Mr M McKenna

Project Ty Glen Menai
Aber Foreshore Road
Llanfagan, Caermerfon

Drawing PROPOSED HOTEL
ELEVATIONS, SECTIONS

Line ignored dimensions do not scale from drawing.
All levels and dimensions to be checked on site.
Drawing to be read in conjunction with all relevant documents.
© David Tyrer. All rights reserved.

Date September 2010 Scale 1:100 @ A1
Drawn dt Checked

Drawing No 253-P105 Rev

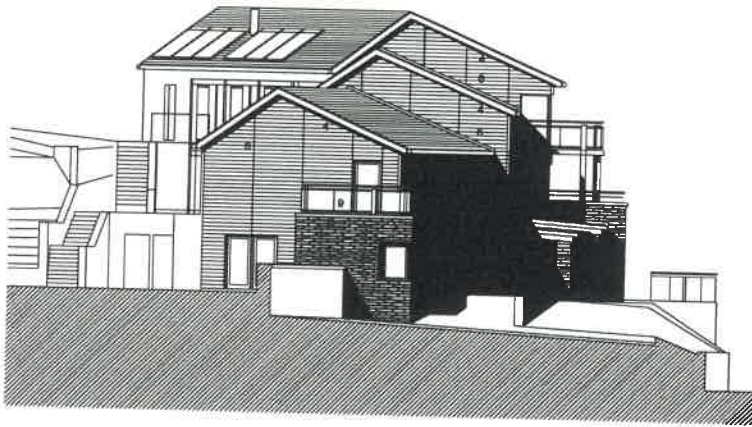

EAST ELEVATION
scale 1:100 @ A1

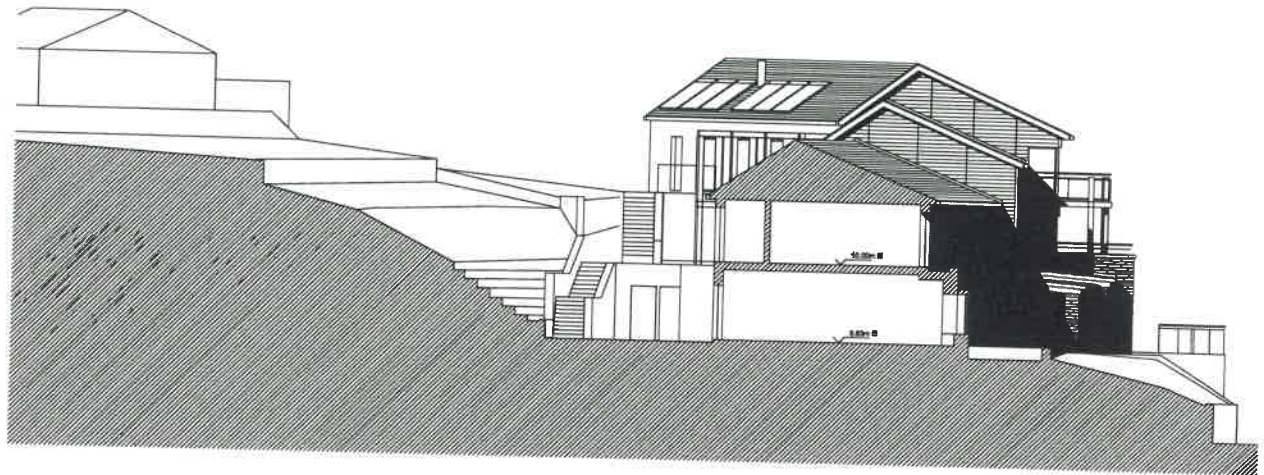

SECTION AA
scale 1:100 @ A1

Cynllun Diwygiedig
Amended Plan

MATERIALS

- 1 Penrhyn Heather Blue slate cut slab wall facing
- 2 Welsh slate coping
- 3 Natural Welsh slate roof finish
- 4 Timber roof eaves, verge and soffit cladding
- 5 Natural aluminium RW gutters and downpipes
- 6 Horizontal timber cladding
- 7 Windows and doors: ground floor, hardwood/acacia
first and second floor, uPVC (triple glazing on north elevation)
- 8 Oak frame balcony structure
- 9 Oak, glass and stainless steel balustrade with HW handrail
- 10 Lead roof with rolled joints

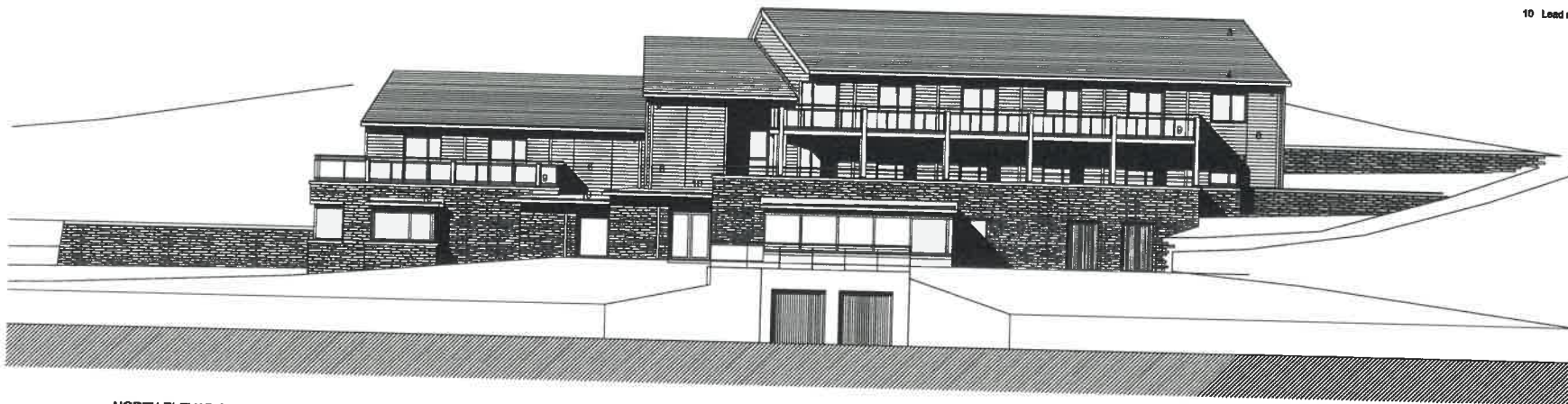

NORTH ELEVATION
scale 1:100 @ A1

DAVID TYRER DP ARCH RIBA
CHARTERED ARCHITECT

21 Brooklands Buildings, Bath, BA1 6PA
Tel 01225 319659

Client Mr M McKenna

Project Ty Glas Menai
Aber Foreshore Road
Llanfeglan, Coesmarfon

Drawing PROPOSED HOTEL
ELEVATIONS, SECTION

Line Weight: dimensions: do not scale from drawing.
All trade and dimensions to be checked on site.
Drawing to be read in conjunction with all relevant documents.
© David Tyrer. All rights reserved.

Date September 2010 Scale 1:100 @ A1
Drawn dt Checked

Drawing No 253. P 104 Rev

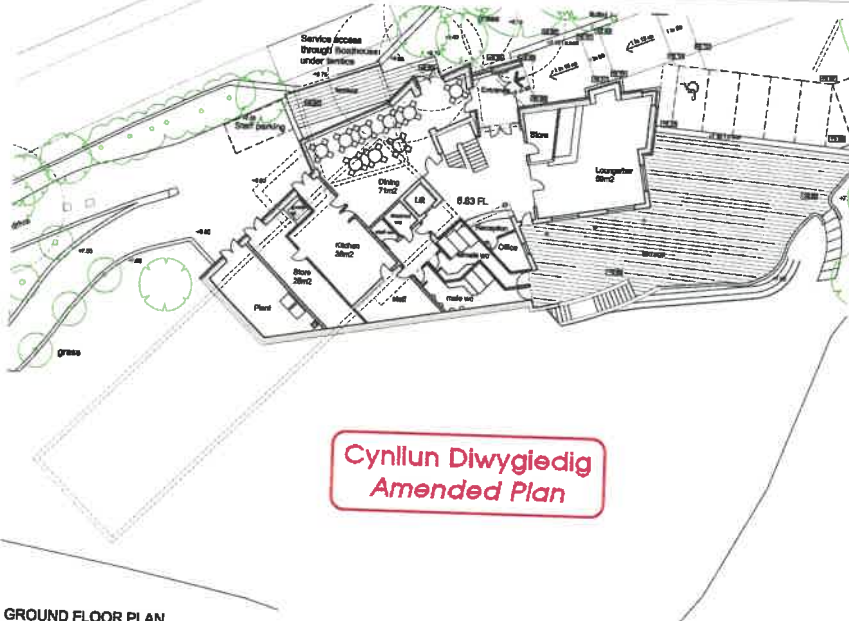

**Cynllun Diwygiedig
Amended Plan**

GROUND FLOOR PLAN
scale 1:200 @ A1

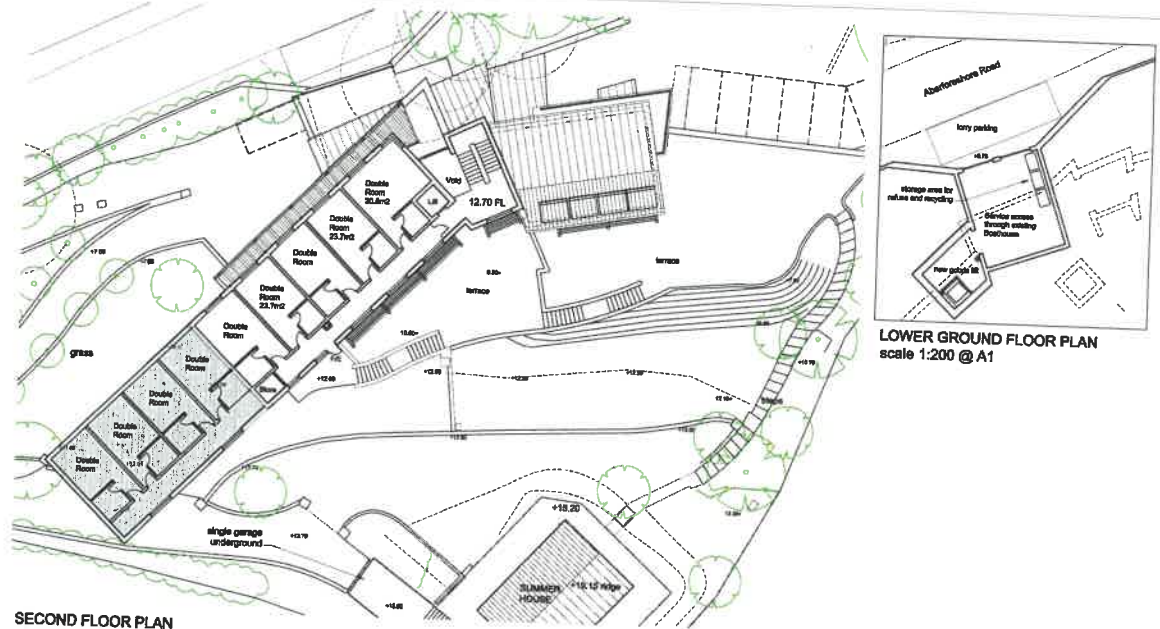

LOWER GROUND FLOOR PLAN
scale 1:200 @ A1

SECOND FLOOR PLAN
scale 1:200 @ A1

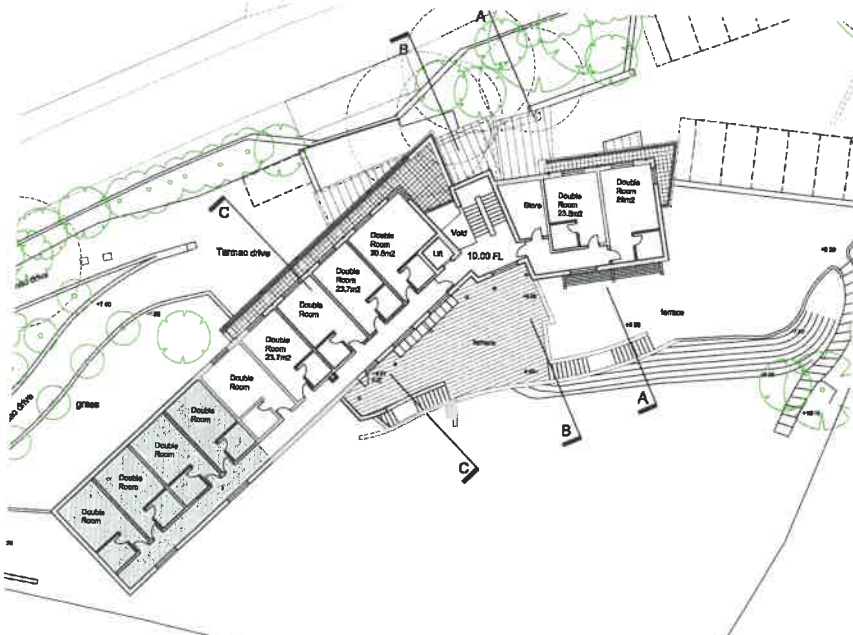

FIRST FLOOR PLAN
scale 1:200 @ A1

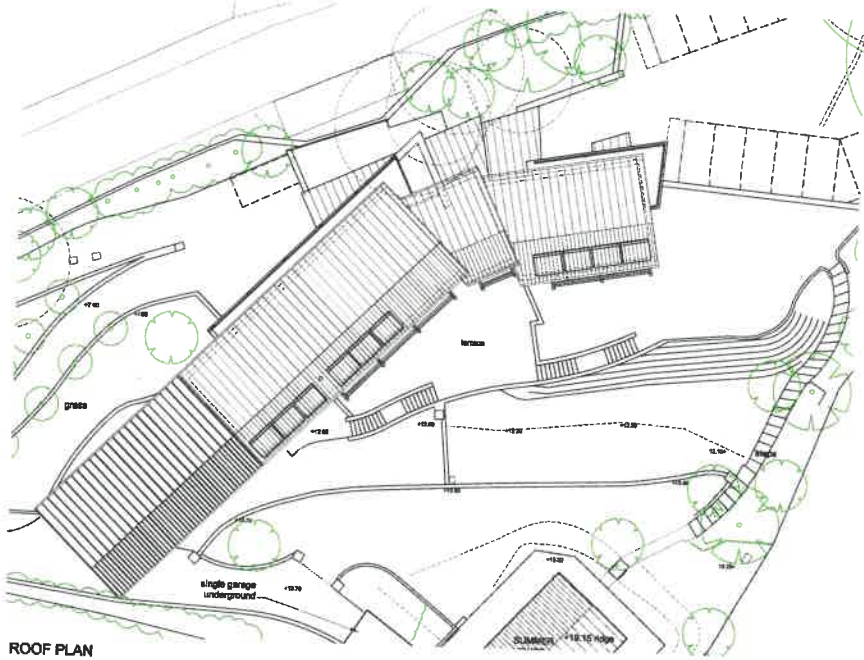

ROOF PLAN
scale 1:200 @ A1

Revisions		Revisions		Revisions		Revisions	
Rev	Date	Rev	Date	Rev	Date	Rev	Date
A	15.11.17						
Pool omitted from design							

All dimensions to be checked on site. Plotted dimensions to be read in preference to marked. KDP accepts no responsibility for any constructional amendments to the drawing and does not permit unauthorised copying of the drawing. This drawing is copyright and remains the property of KDP unless otherwise agreed.

KDP
KIDDELL PARTNERSHIP

THE KEITH DAVIDSON PARTNERSHIP
CHARTERED ARCHITECTS - PROJECT MANAGEMENT - INTERIORS

13 Seymour Terrace
Seymour Street
Llanelli
L31 5PZ

Client: **Mick McKenna**
Ty Glan Mersal
Llanfaglan, Caernarfon

Telephone: +44 (0) 151 708 7777
Facsimile: +44 (0) 151 708 6099
Email: info@kdparchitects.com
Website: www.kdparchitects.com

PRELIMINARY

Job number:
Gen-Eng

103

A

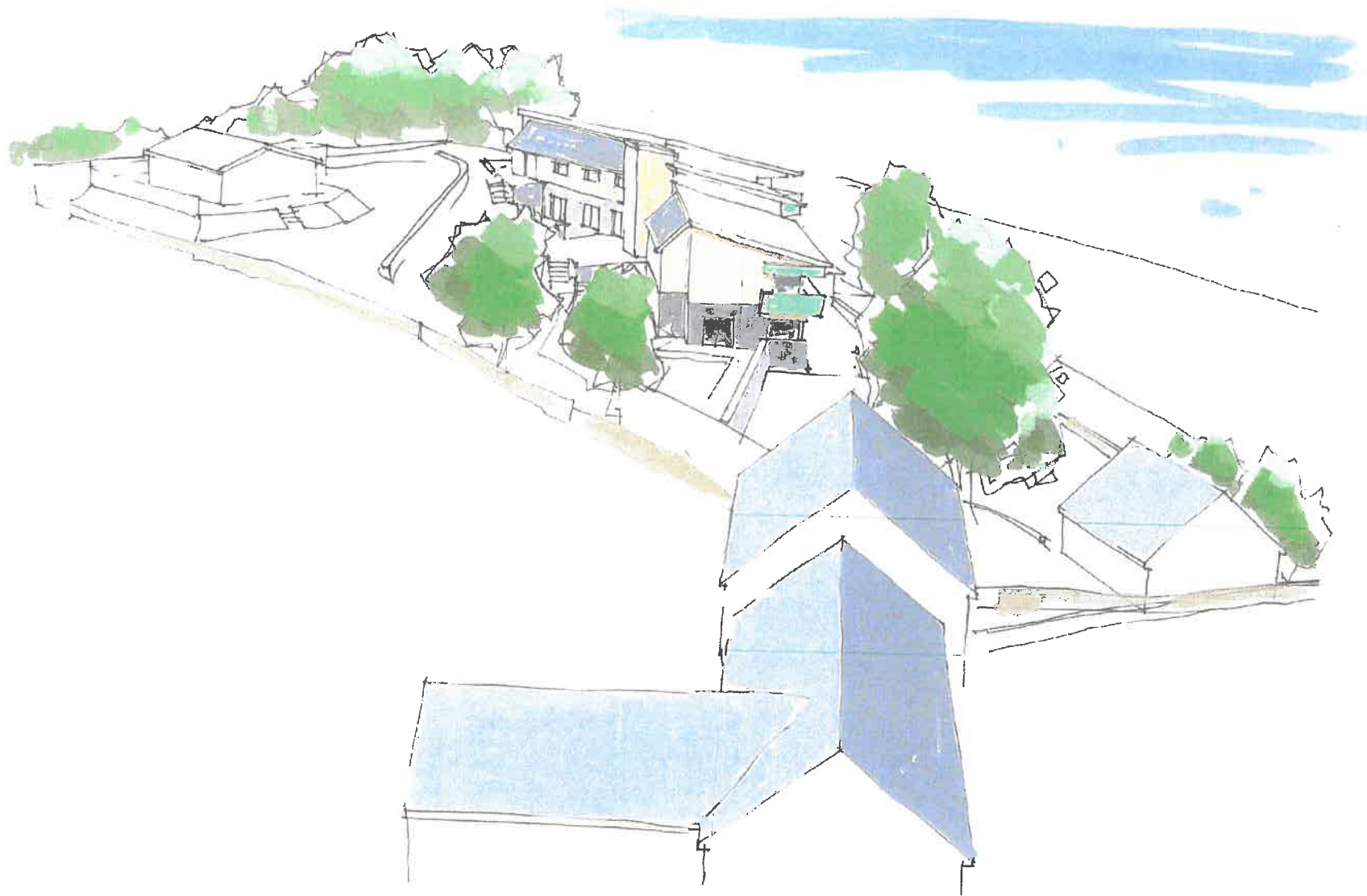

5
18

Client Mr M McKenna

Project Ty Glan Menai, Aber Foreshore Road
Llanfaglan, Caernarfon

Drawing Sketch Perspective 2

Drawn dt

Checked

DAVID TYRER DIP ARCH RIBA
CHARTERED ARCHITECT

21 Brookleaze Buildings, Bath, BA1 6RA Tel 01225 313858

Scale nts

Date Sept 09

Drawing No 253/SK108

Rev

© David Tyrer. All rights reserved

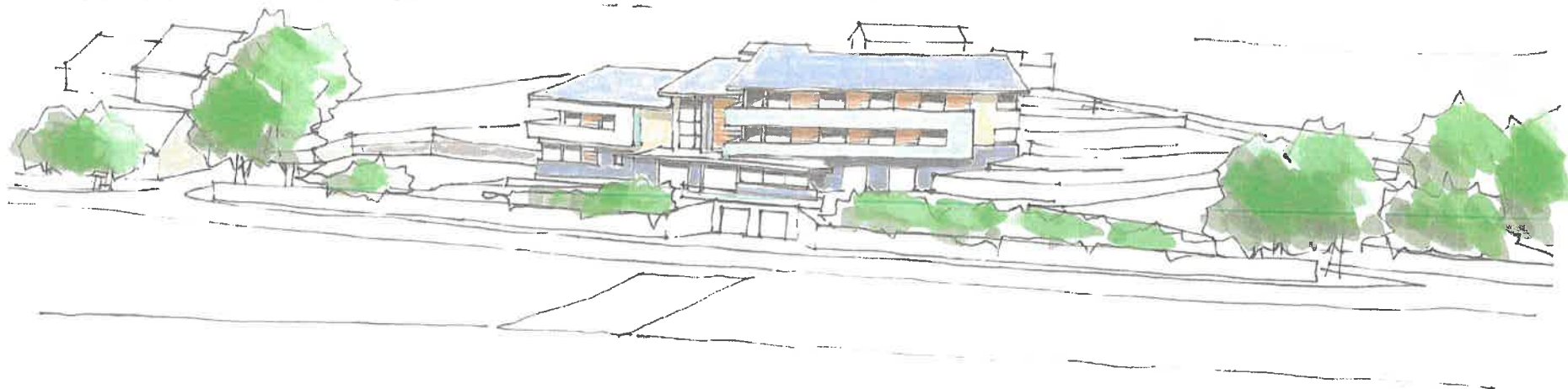

Client Mr M McKenna

Project Ty Glan Menai, Aber Foreshore Road
Llanfaglan, Caernarfon

Drawing Sketch Perspective 3

Drawn dt

Checked

DAVID TYRER DIP ARCH RIBA
CHARTERED ARCHITECT

21 Brookleaze Buildings, Bath, BA1 6RA Tel 01225 313858

Scale nts

Date Sept 09

Drawing No 253/SK109

Rev

© David Tyrer. All rights reserved



Client Mr M McKenna

Project Ty Glan Menai, Aber Foreshore Road
Llanfaglan, Caernarfon

Drawing Sketch Perspective 4

Drawn dt

Checked

DAVID TYRER DIP ARCH RIBA
CHARTERED ARCHITECT

21 Brookleaze Buildings, Bath, BA1 6RA Tel 01225 313858

Scale n/a

Date Sept 09

Drawing No **253/SK110** Rev

© David Tyrer. All rights reserved



Client Mr M McKenna

Project Ty Gfan Menai, Aber Foreshore Road
Llanfaglan, Caemarfon

Drawing Sketch Perspective 1

Drawn dt

Checked

DAVID TYRER DIP ARCH RIBA
CHARTERED ARCHITECT

21 Brookleaze Buildings, Bath, BA1 6RA Tel 01225 313658

Scale nts

Date Sept 09

Drawing No 253/SK107

Rev

© David Tyrer. All rights reserved