

# **C20/0649/44/LL**

**Cais ar gyfer gosod pwerdy ~5MWe nwy wrth gefn gyda  
isadeiledd cysylltiol**

***Application for the erection of an ~5MWe gas fired  
standby power station and associated infrastructure.***

**Tir ger Gelert, Penamser, Porthmadog  
LL49 9NX**

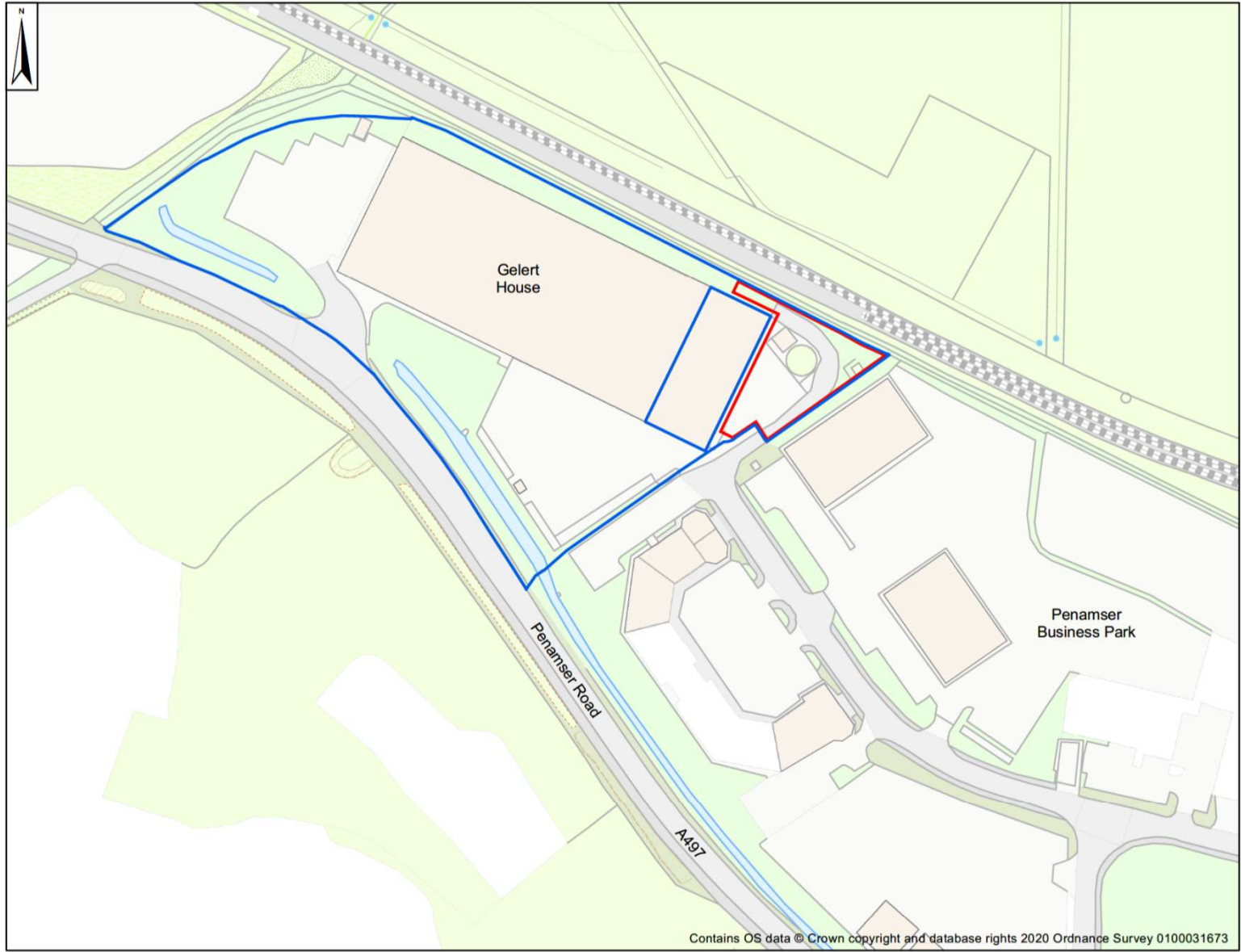

Porthmadog  
Redline Plan

- Landowner's Property
- Site Extent

Contains OS data © Crown copyright and database rights 2020 Ordnance Survey 0100031673

0 25 50 100 Meters

1:1,250 at A3

Date 30-Jul-20  
 Site information  
 Porthmadog  
 Grid 255974 339298  
 Site Area 1395.68 sq m



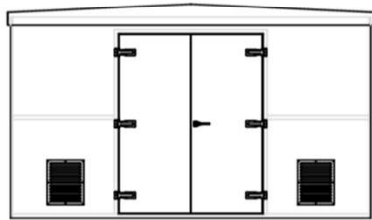

**FRONT ELEVATION**

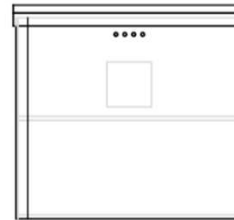

**SIDE ELEVATION**

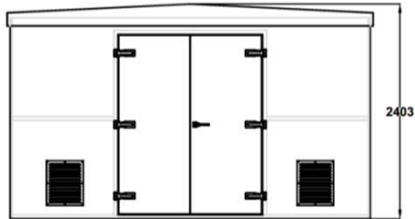

**REAR ELEVATION**

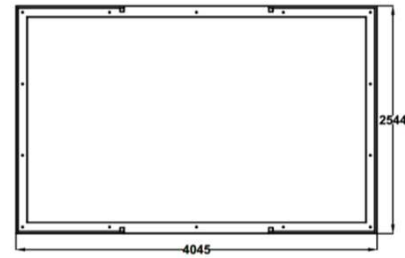

**PLAN VIEW**

**Finishes To Be Confirmed  
And Agreed With LPA**

Rev	Date	By	Details	Apr'd
A	08-10-18	JS	First Issue	JA



CONRAD ENERGY LIMITED  
UNIT 5 & 6, WINDMILL COURT, BLACKLANDS WAY, ABBEYDON MK35 7EP,  
OXFORDSHIRE, ENGLAND. TEL: 01295 252525. WWW.CONRADENERGY.CO.UK

**THIS DOCUMENT IS THE PROPERTY OF CONRAD ENERGY LTD. IT  
CONTAINS PROPRIETARY AND CONFIDENTIAL INFORMATION  
WHICH MUST NOT BE DUPLICATED, USED OR DISCLOSED OTHER  
THAN AS EXPRESSLY AUTHORIZED BY CONRAD ENERGY LTD  
OR ITS REPRESENTATIVE © 2018**

<b>PROJECT</b>	Generic		
<b>CLIENT</b>	Conrad Energy		
<b>TITLE</b>	Gas Kiosk Specification		
<b>Scale</b>	1:50	<b>Dwg. No.</b>	GEN-SP-01
<b>Size</b>	A3		

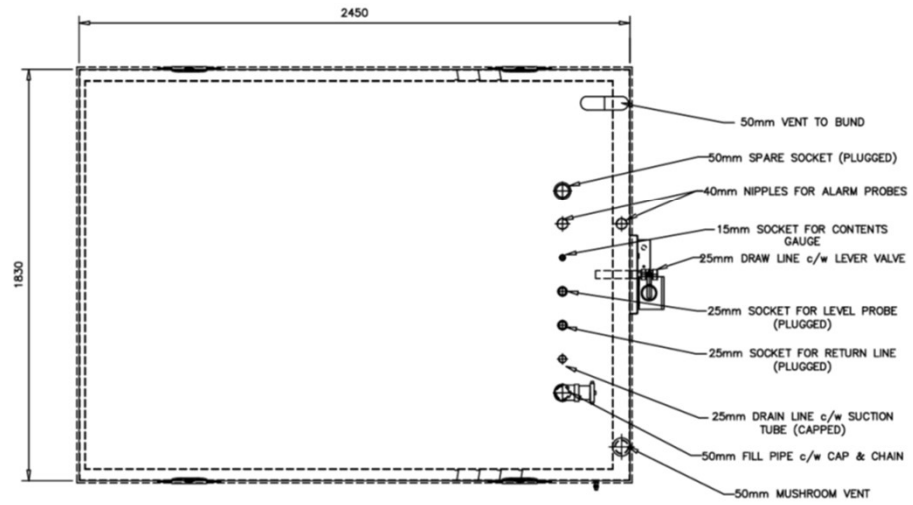

PLAN VIEW

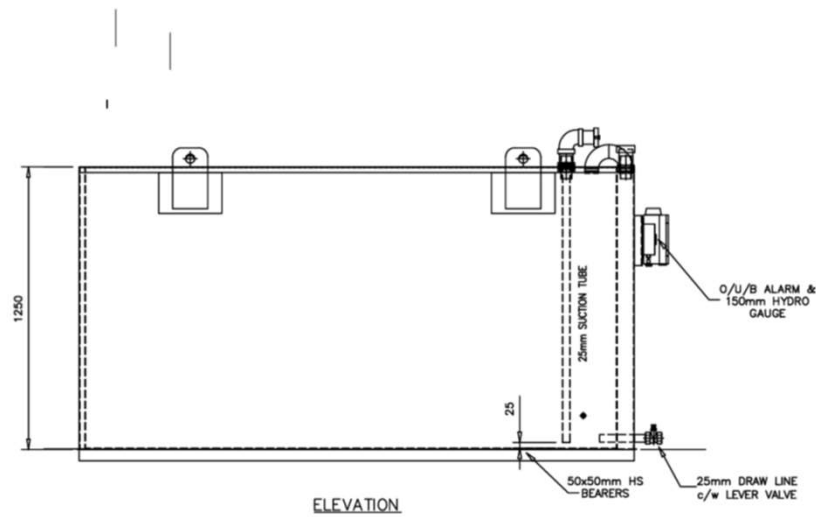

ELEVATION

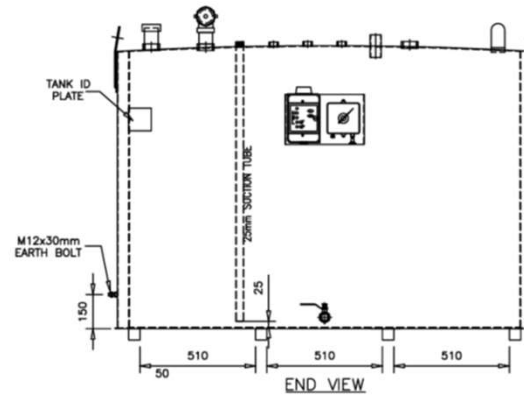

END VIEW

**Finishes To Be Confirmed  
And Agreed With LPA**

Rev	Date	By	Details	JA
A	08-10-18	JS	First Issue	JA



CONRAD ENERGY LIMITED  
UNIT 15 A.S. INDUSTRIAL COURT, BLACKBURN ROAD, WARRINGTON CH10 1BT  
T: +44(0)1875 529462 E: info@conradenergy.co.uk W: www.conradenergy.co.uk  
Registered in England. Registered No. 11316046. Registered Office: 15/16/17

THIS DOCUMENT IS THE PROPERTY OF CONRAD ENERGY LTD. IT  
CONTAINS PROPRIETARY AND CONFIDENTIAL INFORMATION  
WHICH MUST NOT BE DUPLICATED, USED OR DISCLOSED OTHER  
THAN AS EXPRESSLY AUTHORIZED BY CONRAD ENERGY LTD  
OR ITS REPRESENTATIVE. ©2018

PROJECT	Generic		
CLIENT	Conrad Energy		
TITLE	Oil Tank Specification		
Scale	1:20	Draw No.	GEN-SP-03
Size	A3		

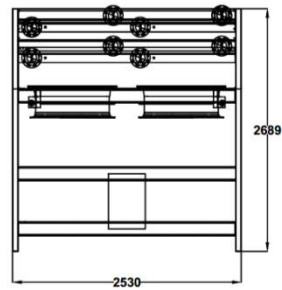

**FRONT/REAR VIEW**

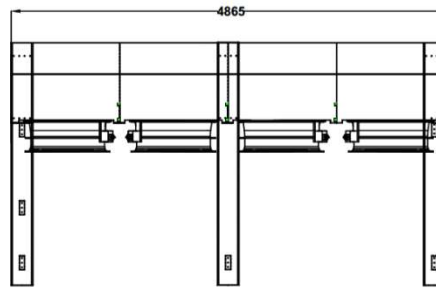

**SIDE VIEW**

**Finishes To Be Confirmed  
And Agreed With LPA**

<b>A</b>	<b>08-10-18</b>	<b>JB</b>	<b>First Issue</b>	<b>JA</b>
<b>Rev</b>	<b>Date</b>	<b>By</b>	<b>Details</b>	<b>App'd</b>



CONRAD ENERGY LIMITED  
UNITS 0 & 1, SHEDDING COURT, BALACRAVE WAY, AMBROSE DDB1 1BT  
T: +44 (0)1203 201818 | E: info@conradenergy.co.uk | www.conradenergy.co.uk  
Registered in England. Registered Office: 11, The Green, Great Gaddesden, Herts SG11 1JG

**THIS DOCUMENT IS THE PROPERTY OF CONRAD ENERGY LTD. IT CONTAINS PROPRIETARY AND CONFIDENTIAL INFORMATION WHICH MUST NOT BE DUPLICATED, USED OR DISCLOSED OTHER THAN AS EXPRESSLY AUTHORIZED BY CONRAD ENERGY LTD OR ITS REPRESENTATIVE. © 2018**

**PROJECT**      **Generic**

**CLIENT**        **Conrad Energy**

**TITLE**  
**Radiator Specification**

<b>Scale</b>	1:50	<b>Org. No.</b> <b>GEN-SP-04</b>
<b>Size</b>	A3	

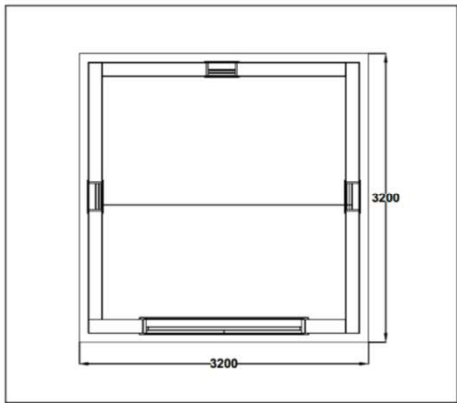

**PLAN VIEW**

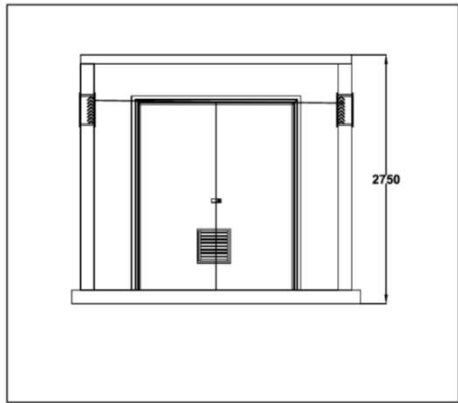

**FRONT VIEW**

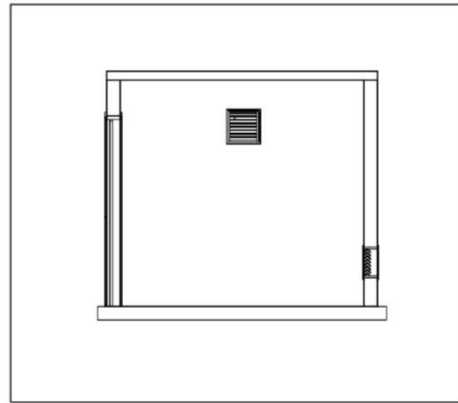

**SIDE VIEW**

**Finishes To Be Confirmed  
And Agreed With LPA**

Rev	Date	By	Details	App'd
A	08-10-18	JS	First Issue	JA



CONRAD ENERGY LIMITED  
UNIT 15, WINDMILL COURT, BARNING ROAD, BARNING, LINCOLN LN1 1BY  
T: 01509 523948 E: info@conradenergy.co.uk W: www.conradenergy.co.uk  
Registered in England. Registered Number: 11191646. Registered Office: Barning Road, Barning, Lincoln LN1 1BY

**THIS DOCUMENT IS THE PROPERTY OF CONRAD ENERGY LTD. IT CONTAINS PROPRIETARY AND CONFIDENTIAL INFORMATION WHICH MUST NOT BE DUPLICATED, USED OR DISCLOSED OTHER THAN AS EXPRESSLY AUTHORIZED BY CONRAD ENERGY LTD OR ITS REPRESENTATIVE ©2018**

PROJECT	Generic	
CLIENT	Conrad Energy	
TITLE	HV Client Specification	
Scale	1:50	Dwg. No. GEN-SP-05
Size	A3	

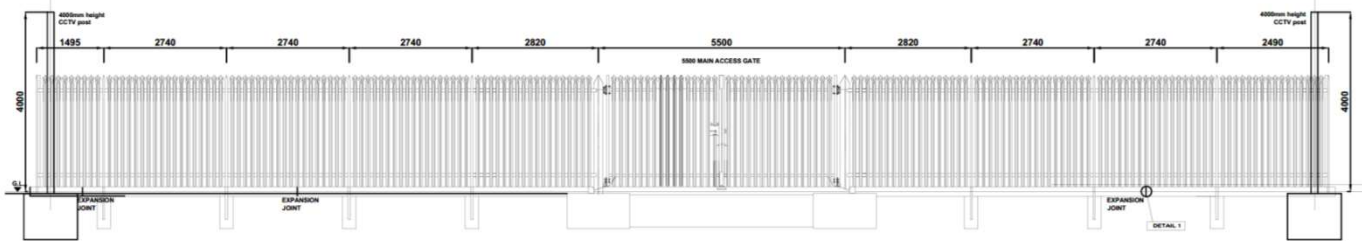

FENCE FRONT ELEVATION

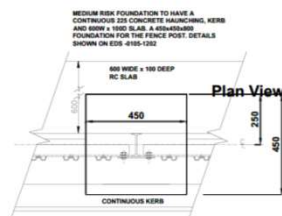

FOUNDATION PLAN

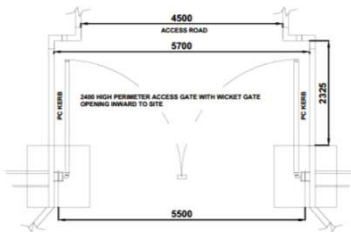

ACCESS GATE PLAN



PANEL ELEVATION

FENCE HEIGHT	PALE	POST	EMBEDDED LENGTH	MAX HORZ. SPACING	PLAN DIMS FOR FENCE POST FOUNDATIONS	RAIL	PALES OVERSAIL	
							TOP	BOTTOM
2400 (GP24)	CORRUGATE D "W" 3.0 THICK	102 x 44 x 7 R.S.J	725	2750	350x350	65 x 50 x 5	300	210

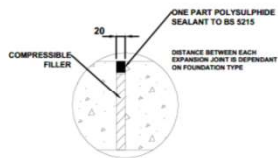

DETAIL 1 EXPANSION JOINT



DETAIL 1 PLAN EXPANSION JOINT (IF REQUIRED)

Finishes To Be Confirmed And Agreed With LPA

A	08-10-18	JB	First Issue	JA
Rev	Date	By	Details	Apr'18



CONRAD ENERGY LIMITED  
UNIT 5 & 6, ANDERSON COURT, BLACKLANDS WAY, ANDERSON CREEK, 151  
7, HINDSIDE DRIVE, HINDSIDE, WINDERMERE, WA 6008

THIS DOCUMENT IS THE PROPERTY OF CONRAD ENERGY LTD. IT CONTAINS PROPRIETARY AND CONFIDENTIAL INFORMATION WHICH MUST NOT BE DUPLICATED, USED OR DISCLOSED OTHER THAN AS EXPRESSLY AUTHORIZED BY CONRAD ENERGY LTD OR ITS REPRESENTATIVE © 2018

PROJECT: Generic

CLIENT: Conrad Energy

TITLE: Typical Fence/Gate Detail

Scale	1:100	Dwg No.	GEN-SP-06
Site	A3		

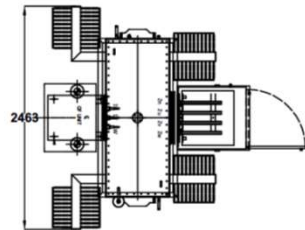
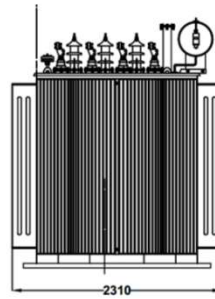
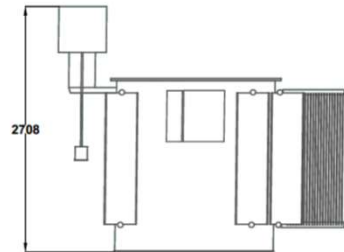

**Finishes To Be Confirmed  
And Agreed With LPA**

Rev	Date	By	Details	Apr'd
A	08-10-18	JS	First Issue	JA



CONRAD ENERGY LIMITED  
UNITED KINGDOM COURT BLACKLIPS WAY ABINGDON OX14 3EP  
OXFORD OX1 0DE, ENGLAND  
www.conradenergy.co.uk

**THIS DOCUMENT IS THE PROPERTY OF CONRAD ENERGY LTD. IT  
CONTAINS PROPRIETARY AND CONFIDENTIAL INFORMATION  
WHICH MUST NOT BE DUPLICATED, USED OR DISCLOSED OTHER  
THAN AS EXPRESSLY AUTHORIZED BY CONRAD ENERGY LTD  
OR ITS REPRESENTATIVE © 2018**

**PROJECT**      **Generic**

**CLIENT**       **Conrad Energy**

**TITLE**  
**Typical Transformer**

Scale	1:50	Dwg. No.
Size	A3	
		<b>GEN-SP-08</b>





**REAR VIEW**

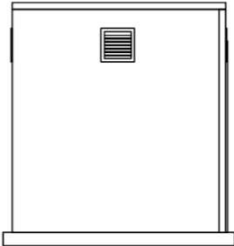

**SIDE VIEW**

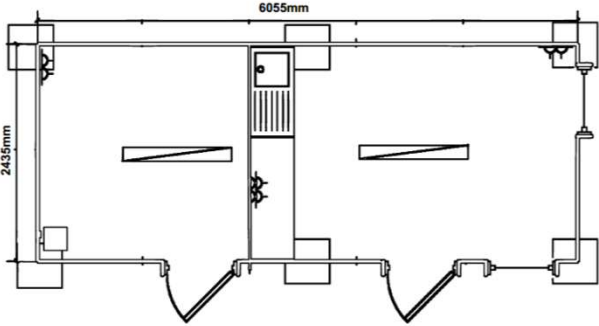

**PLAN VIEW**

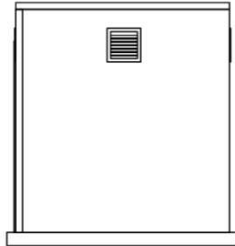

**SIDE VIEW**

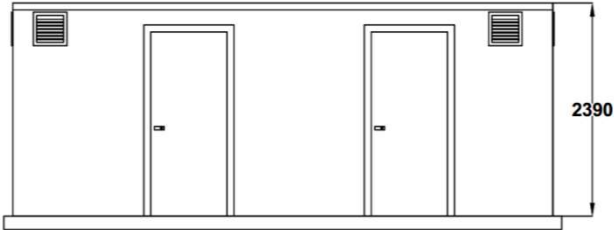

**FRONT VIEW**

**Finishes To Be Confirmed  
And Agreed With LPA**



<b>A</b>	<b>08-10-18</b>	<b>JS</b>	<b>First Issue</b>	<b>JA</b>
<b>Rev</b>	<b>Date</b>	<b>By</b>	<b>Details</b>	<b>Apr'd</b>



CONRAD ENERGY LIMITED  
UNIT 10 & 11, WARRINGTON COURT, BLACKBURN ROAD, WARRINGTON, CH10 1BY  
T: +44 (0)1203 221111 E: info@conradenergy.co.uk W: www.conradenergy.co.uk  
Approved Supplier to: Amazon, Asda, Aldi, Lidl, Sainsbury's, M&S, Morrisons, Iceland, Iceland, Iceland

THIS DOCUMENT IS THE PROPERTY OF CONRAD ENERGY LTD. IT  
CONTAINS PROPRIETARY AND CONFIDENTIAL INFORMATION  
WHICH MUST NOT BE DUPLICATED, USED OR DISCLOSED OTHER  
THAN AS EXPRESSLY AUTHORIZED BY CONRAD ENERGY LTD  
OR ITS REPRESENTATIVE. ©2018

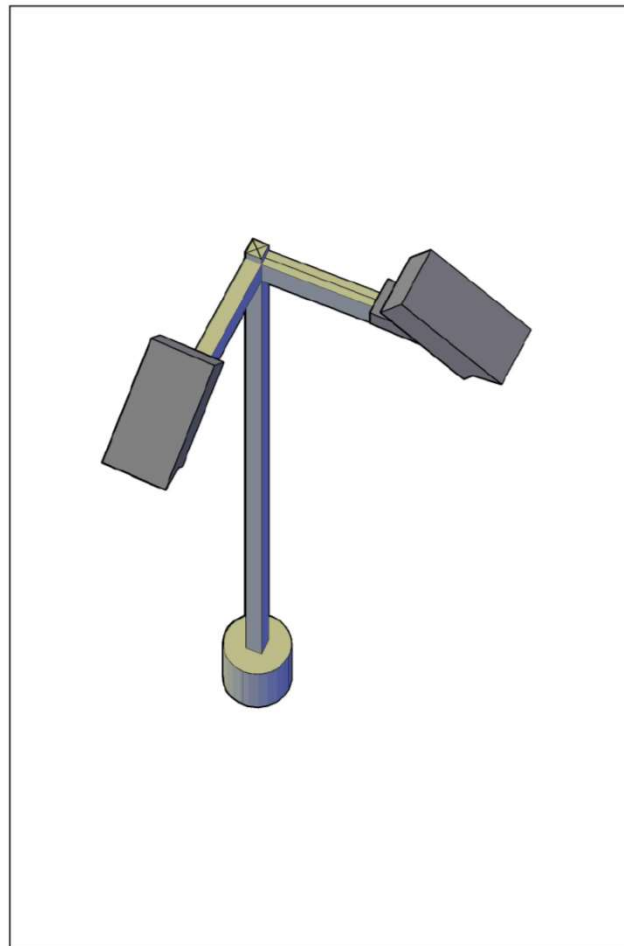
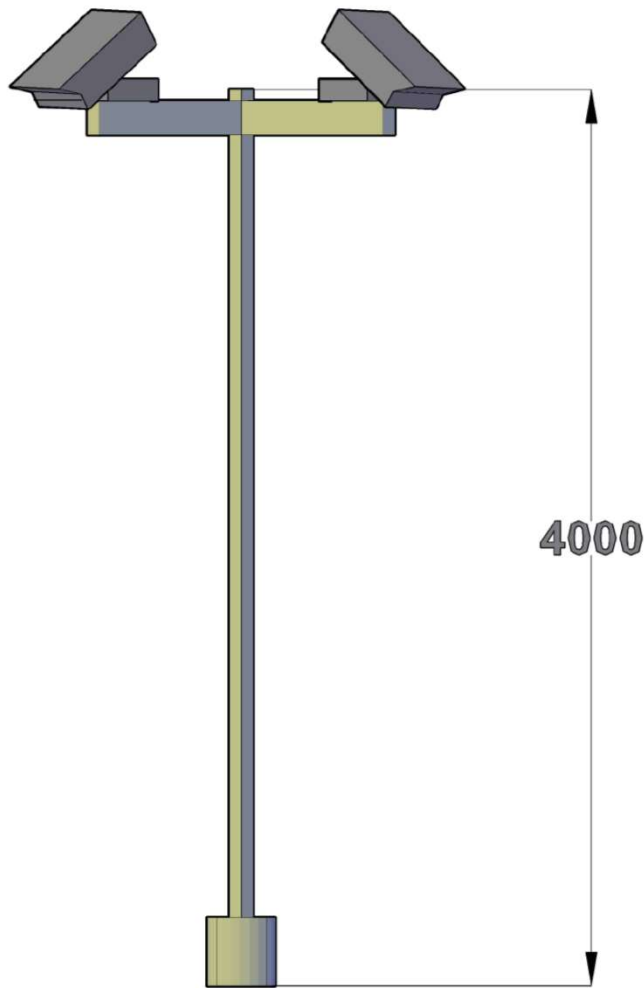
<b>PROJECT</b>	<b>Generic</b>		
<b>CLIENT</b>	<b>Conrad Energy</b>		
<b>TITLE</b>	<b>Amenity Cabin</b>		
<b>Scale</b>	<b>1:50</b>	<b>Dwg. No.</b>	<b>GEN-SP-09</b>
<b>Size</b>	<b>A3</b>		



Finishes To Be Confirmed  
And Agreed With LPA

Rev	Date	By	Details	Apr'd
A	08-10-18	JB	First Issue	JA



CONRAD ENERGY LIMITED  
UNIT 12, 13, 14, 15, 16, 17, 18, 19, 20, 21, 22, 23, 24, 25, 26, 27, 28, 29, 30, 31, 32, 33, 34, 35, 36, 37, 38, 39, 40, 41, 42, 43, 44, 45, 46, 47, 48, 49, 50, 51, 52, 53, 54, 55, 56, 57, 58, 59, 60, 61, 62, 63, 64, 65, 66, 67, 68, 69, 70, 71, 72, 73, 74, 75, 76, 77, 78, 79, 80, 81, 82, 83, 84, 85, 86, 87, 88, 89, 90, 91, 92, 93, 94, 95, 96, 97, 98, 99, 100, 101, 102, 103, 104, 105, 106, 107, 108, 109, 110, 111, 112, 113, 114, 115, 116, 117, 118, 119, 120, 121, 122, 123, 124, 125, 126, 127, 128, 129, 130, 131, 132, 133, 134, 135, 136, 137, 138, 139, 140, 141, 142, 143, 144, 145, 146, 147, 148, 149, 150, 151, 152, 153, 154, 155, 156, 157, 158, 159, 160, 161, 162, 163, 164, 165, 166, 167, 168, 169, 170, 171, 172, 173, 174, 175, 176, 177, 178, 179, 180, 181, 182, 183, 184, 185, 186, 187, 188, 189, 190, 191, 192, 193, 194, 195, 196, 197, 198, 199, 200, 201, 202, 203, 204, 205, 206, 207, 208, 209, 210, 211, 212, 213, 214, 215, 216, 217, 218, 219, 220, 221, 222, 223, 224, 225, 226, 227, 228, 229, 230, 231, 232, 233, 234, 235, 236, 237, 238, 239, 240, 241, 242, 243, 244, 245, 246, 247, 248, 249, 250, 251, 252, 253, 254, 255, 256, 257, 258, 259, 260, 261, 262, 263, 264, 265, 266, 267, 268, 269, 270, 271, 272, 273, 274, 275, 276, 277, 278, 279, 280, 281, 282, 283, 284, 285, 286, 287, 288, 289, 290, 291, 292, 293, 294, 295, 296, 297, 298, 299, 300, 301, 302, 303, 304, 305, 306, 307, 308, 309, 310, 311, 312, 313, 314, 315, 316, 317, 318, 319, 320, 321, 322, 323, 324, 325, 326, 327, 328, 329, 330, 331, 332, 333, 334, 335, 336, 337, 338, 339, 340, 341, 342, 343, 344, 345, 346, 347, 348, 349, 350, 351, 352, 353, 354, 355, 356, 357, 358, 359, 360, 361, 362, 363, 364, 365, 366, 367, 368, 369, 370, 371, 372, 373, 374, 375, 376, 377, 378, 379, 380, 381, 382, 383, 384, 385, 386, 387, 388, 389, 390, 391, 392, 393, 394, 395, 396, 397, 398, 399, 400, 401, 402, 403, 404, 405, 406, 407, 408, 409, 410, 411, 412, 413, 414, 415, 416, 417, 418, 419, 420, 421, 422, 423, 424, 425, 426, 427, 428, 429, 430, 431, 432, 433, 434, 435, 436, 437, 438, 439, 440, 441, 442, 443, 444, 445, 446, 447, 448, 449, 450, 451, 452, 453, 454, 455, 456, 457, 458, 459, 460, 461, 462, 463, 464, 465, 466, 467, 468, 469, 470, 471, 472, 473, 474, 475, 476, 477, 478, 479, 480, 481, 482, 483, 484, 485, 486, 487, 488, 489, 490, 491, 492, 493, 494, 495, 496, 497, 498, 499, 500, 501, 502, 503, 504, 505, 506, 507, 508, 509, 510, 511, 512, 513, 514, 515, 516, 517, 518, 519, 520, 521, 522, 523, 524, 525, 526, 527, 528, 529, 530, 531, 532, 533, 534, 535, 536, 537, 538, 539, 540, 541, 542, 543, 544, 545, 546, 547, 548, 549, 550, 551, 552, 553, 554, 555, 556, 557, 558, 559, 560, 561, 562, 563, 564, 565, 566, 567, 568, 569, 570, 571, 572, 573, 574, 575, 576, 577, 578, 579, 580, 581, 582, 583, 584, 585, 586, 587, 588, 589, 590, 591, 592, 593, 594, 595, 596, 597, 598, 599, 600, 601, 602, 603, 604, 605, 606, 607, 608, 609, 610, 611, 612, 613, 614, 615, 616, 617, 618, 619, 620, 621, 622, 623, 624, 625, 626, 627, 628, 629, 630, 631, 632, 633, 634, 635, 636, 637, 638, 639, 640, 641, 642, 643, 644, 645, 646, 647, 648, 649, 650, 651, 652, 653, 654, 655, 656, 657, 658, 659, 660, 661, 662, 663, 664, 665, 666, 667, 668, 669, 670, 671, 672, 673, 674, 675, 676, 677, 678, 679, 680, 681, 682, 683, 684, 685, 686, 687, 688, 689, 690, 691, 692, 693, 694, 695, 696, 697, 698, 699, 700, 701, 702, 703, 704, 705, 706, 707, 708, 709, 710, 711, 712, 713, 714, 715, 716, 717, 718, 719, 720, 721, 722, 723, 724, 725, 726, 727, 728, 729, 730, 731, 732, 733, 734, 735, 736, 737, 738, 739, 740, 741, 742, 743, 744, 745, 746, 747, 748, 749, 750, 751, 752, 753, 754, 755, 756, 757, 758, 759, 760, 761, 762, 763, 764, 765, 766, 767, 768, 769, 770, 771, 772, 773, 774, 775, 776, 777, 778, 779, 780, 781, 782, 783, 784, 785, 786, 787, 788, 789, 790, 791, 792, 793, 794, 795, 796, 797, 798, 799, 800, 801, 802, 803, 804, 805, 806, 807, 808, 809, 810, 811, 812, 813, 814, 815, 816, 817, 818, 819, 820, 821, 822, 823, 824, 825, 826, 827, 828, 829, 830, 831, 832, 833, 834, 835, 836, 837, 838, 839, 840, 841, 842, 843, 844, 845, 846, 847, 848, 849, 850, 851, 852, 853, 854, 855, 856, 857, 858, 859, 860, 861, 862, 863, 864, 865, 866, 867, 868, 869, 870, 871, 872, 873, 874, 875, 876, 877, 878, 879, 880, 881, 882, 883, 884, 885, 886, 887, 888, 889, 890, 891, 892, 893, 894, 895, 896, 897, 898, 899, 900, 901, 902, 903, 904, 905, 906, 907, 908, 909, 910, 911, 912, 913, 914, 915, 916, 917, 918, 919, 920, 921, 922, 923, 924, 925, 926, 927, 928, 929, 930, 931, 932, 933, 934, 935, 936, 937, 938, 939, 940, 941, 942, 943, 944, 945, 946, 947, 948, 949, 950, 951, 952, 953, 954, 955, 956, 957, 958, 959, 960, 961, 962, 963, 964, 965, 966, 967, 968, 969, 970, 971, 972, 973, 974, 975, 976, 977, 978, 979, 980, 981, 982, 983, 984, 985, 986, 987, 988, 989, 990, 991, 992, 993, 994, 995, 996, 997, 998, 999, 1000

PROJECT **Generic**

CLIENT **Conrad Energy**

TITLE **CCTV**

Scale 1:20  
Size A3  
Dwg. No. GEN-SP-10

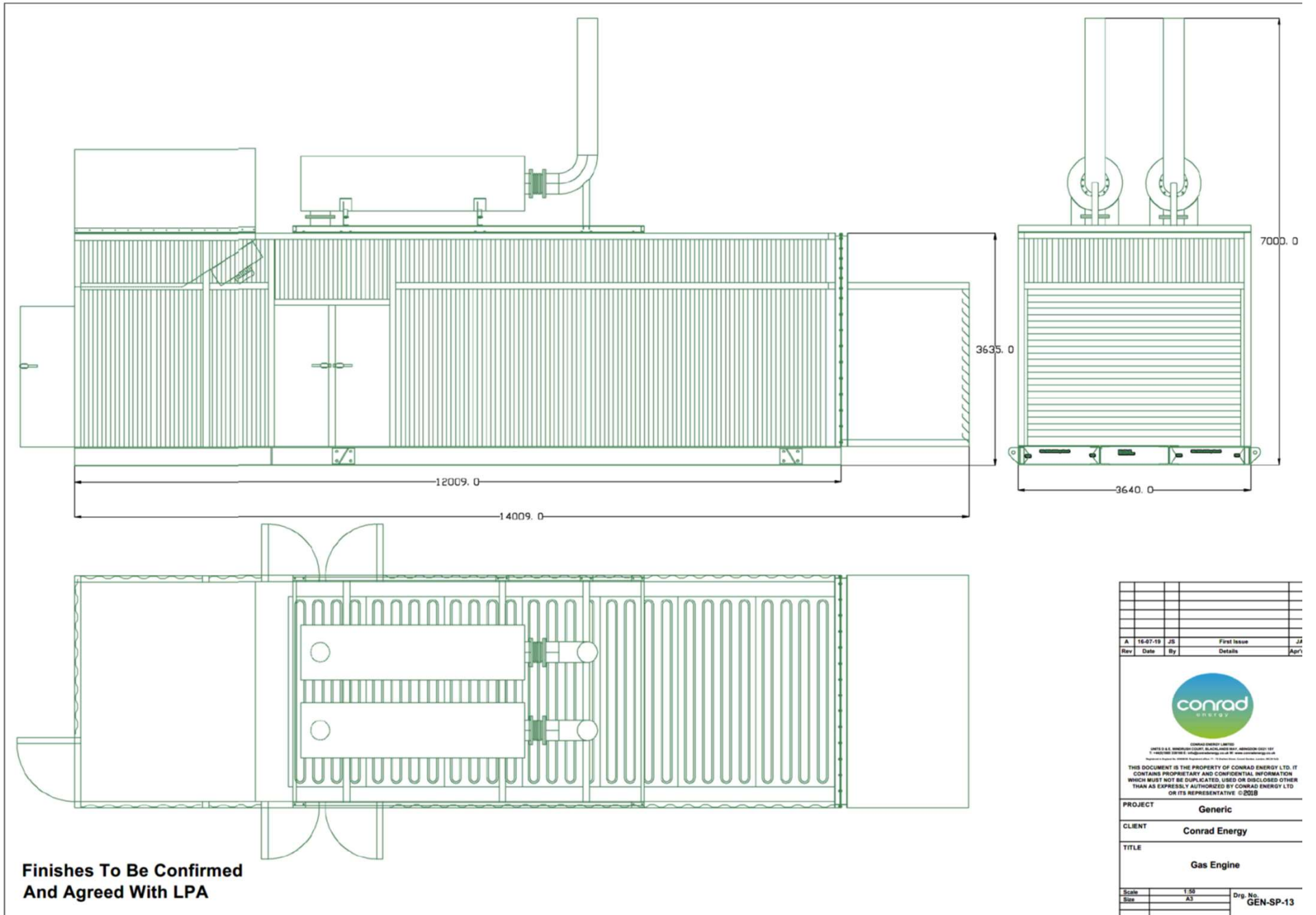

Rev	Date	By	Details	Apr
A	16-07-19	JS	First Issue	JA



CONRAD ENERGY LIMITED  
 UNITED KINGDOM COMPANY, INCORPORATED IN THE UNITED KINGDOM  
 11 HAYWARD STREET, HAYWARD, LONDON, ENGLAND, E16 1JH  
 Registered in England No. 08888488 Registered Office: 11 Hayward Street, London, E16 1JH

THIS DOCUMENT IS THE PROPERTY OF CONRAD ENERGY LTD. IT CONTAINS PROPRIETARY AND CONFIDENTIAL INFORMATION WHICH MUST NOT BE DUPLICATED, USED OR DISCLOSED OTHER THAN AS EXPRESSLY AUTHORIZED BY CONRAD ENERGY LTD OR ITS REPRESENTATIVE © 2018

PROJECT	Generic		
CLIENT	Conrad Energy		
TITLE	Gas Engine		
Scale	1:50	Orig. No.	
Size	A3		GEN-SP-13

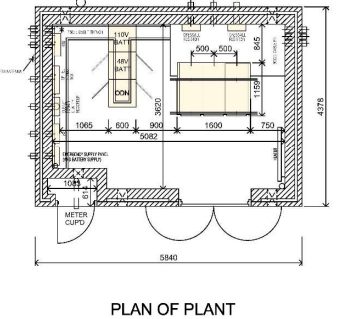
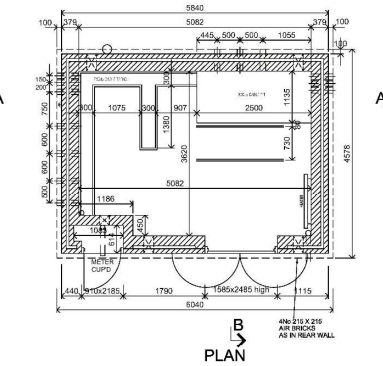
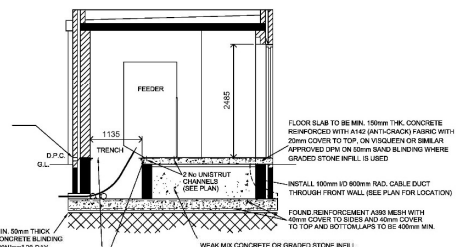
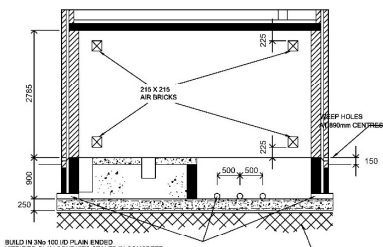
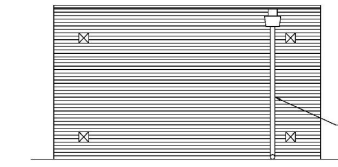
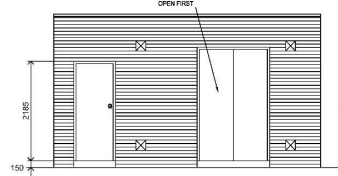
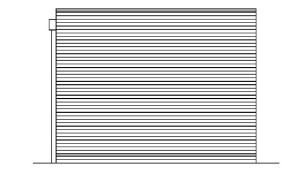
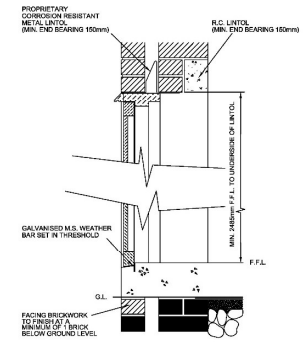
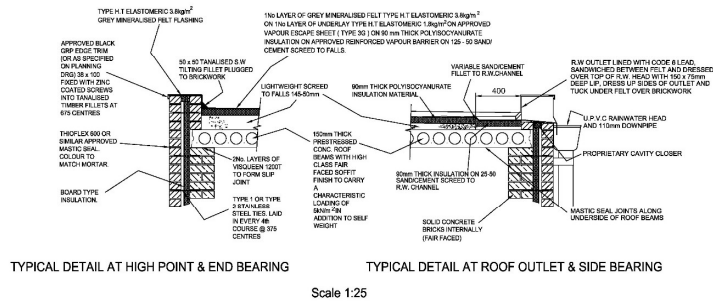

**NOTES**

**General**  
 This drawing is to be read in conjunction with document SUB-03-017 General Specification for the Civil Engineering and Building Design and Construction of Secondary Substations. It is the contractor's responsibility to confirm, before construction, that the details on this drawing are correct as per SUB-03-017.

This is a generic guidance drawing that is deemed suitable for construction. However the contractor should consider all site specific risk that will affect the design and operation of the substation. Proposed substation details are to be submitted for acceptance before installation.

Details shown on this drawing are typical for this type of substation building but may not be suitable for substations housing alternative equipment. The contractor shall satisfy themselves that the appropriate details shown are correct depending on the type of substation being constructed.

**Concrete**  
 General  
 The concrete shall be in accordance with the specification and attain the relevant cub crushing strength at 28 days.

Foundations (Concrete 40N/mm<sup>2</sup> 28-Day Cube Strength)  
 Foundations are to be set on undisturbed inorganic strata that provide the required minimum design safe ground bearing capacity. Minimum bearing capacity to be 75kN/m<sup>2</sup>.

Floor (Concrete 40N/mm<sup>2</sup> 28-Day Cube Strength)  
 Floors of substations housing indoor switchgear shall have a visqueen damp proof membrane installed where graded stone infill is used.  
 A flat, level and smooth floor surface is essential for installation of plant. Tolerances to finished level expressed as a maximum permissible deviation beneath a straight edge with feet placed anywhere on the floor shall not exceed 1mm in 1m or 3mm in 3m. Floors to be cured, prepared & painted with 2 No. Coats of non-slip floor paint on completion.

**Brickwork**  
 General  
 All brickwork below D.P.C. to be H.D. category 3 min. 75N/mm<sup>2</sup> mean compressive strength and max 7% M.A. and durability designation F2 S2 (Ex Engineering Brickwork Class B) in English bond except for exposed faces.  
 External facing brickwork to be H.D. category 1 min. 30N/mm<sup>2</sup> mean compressive strength and max 12% M.A. and durability designation F1 S1 or better.  
 Internal facing brickwork (if any, faced smooth) to be H.D. category 1 min. 30N/mm<sup>2</sup> mean compressive strength and max 12% M.A. and durability designation F1 S1 or better.

Walls  
 External walls to enclosures housing indoor equipment shall be cavity construction that provides, as a minimum, standard thermal insulation values in accordance with the table below. The internal leaf shall be solid brickwork construction minimum 215mm overall thickness. Walls shall be fair-faced plumb and smooth to the interior.  
 Leaves of walls to be tied together by means of type 1 or type 2 stainless steel ties laid in every fourth course at 375mm centres and set back 38mm from outer face. Ties are to be staggered.

**Doors**  
 Details of proposed doors shall be submitted to SPEN for comment, before work commences. Proprietary GRP faced aluminium or steel security doors are the preferred option, unless stated otherwise.  
 An alternative option for hardwood doors (see Drg SP4000543 for details) or GRP doors is also available.

**Cable Trench & Slots/Ramp**  
 On completion of cabling, cable trench to be filled with dry sand and studded with minimum 50mm depth of sand/cement screed over a visqueen membrane (top to be level with F.F.L.).

**Roof**  
 Roofs shall provide a minimum standard thermal insulation values as detailed in the table below.  
 Roof shall be proprietary precast pre-stressed beam and in situ concrete screed topping systems with a fair-faced soffitt finish, sealed joints and with reinforcement to screed where applicable with water proofing as shown in the Typical Detail above.

**Ventilation**  
 Nominal trickle ventilation is to be provided to reduce the risk of condensation.

**Insulation**  
 Substations housing indoor switchgear require insulation. U values for wall and roof shall meet those detailed in the table below:

REGION	ROOF U (W/M <sup>2</sup> K)	WALLS U (W/M <sup>2</sup> K)
SCOTLAND	0.2	0.27
ENGLAND & WALES	0.25	0.35

**Related Typical Deemed to Satisfy Drawings**  
 Harwood Doors SP4000543  
 Meter Cupboards SP4078901

SP PowerSystems Ltd  
 System Design, Drawing Office  
 3 Prenton Way, Prenton, CH43 3ET  
 Telephone 0151 6092491

Typical building detail for 11kV Generation Customer Substation 1MVA and above

Location	TYPICAL			
Drawn	Date	Checked	Date	Approved
ada	01.03.19	ad	01.03.19	
Status	FOR ISSUE		Dwg. No.	Rev.
			SP4148718	
© Copyright property of SP PowerSystems Ltd.				Scale: 1:50
				Sheet: A1

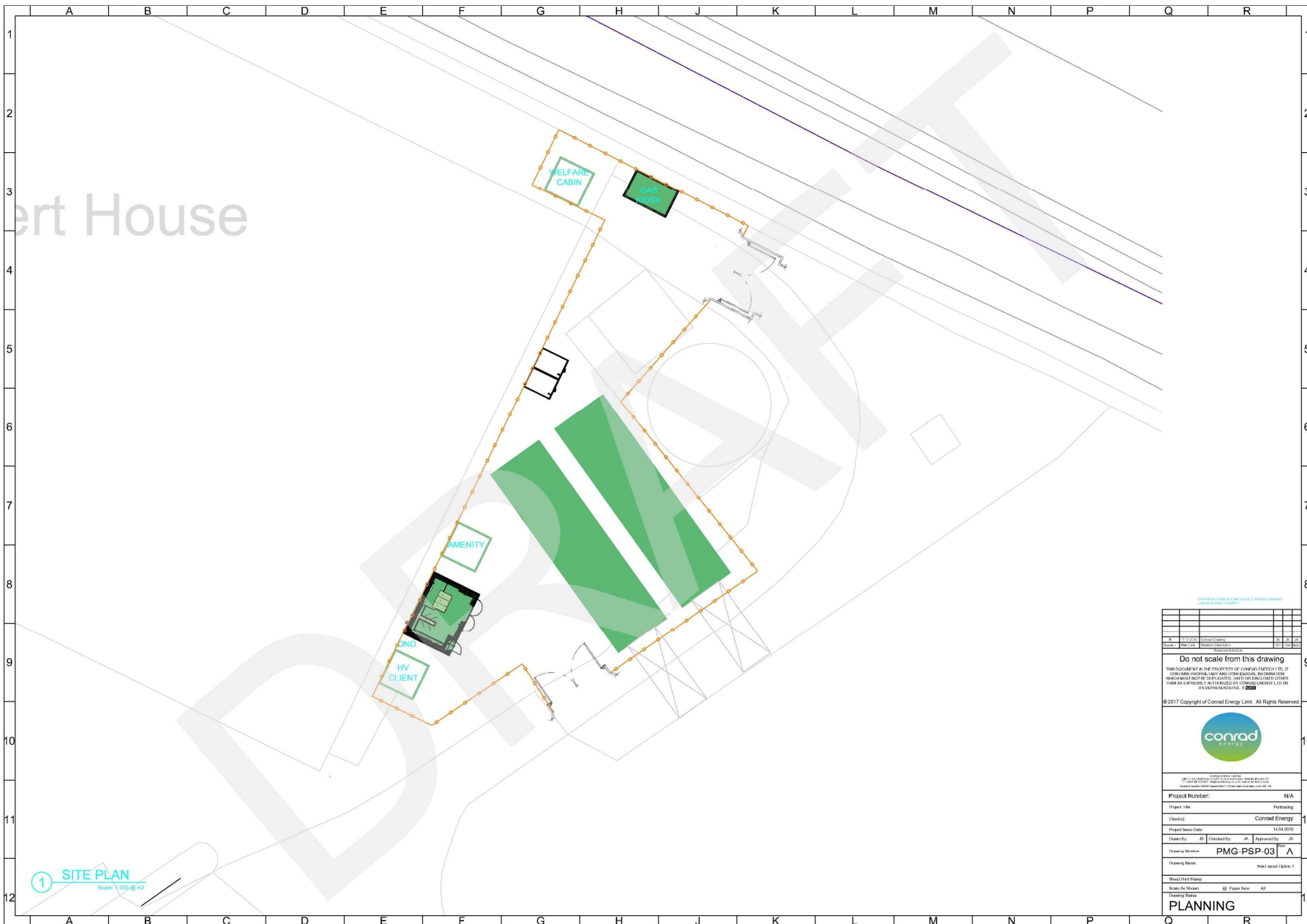

1 SITE PLAN  
Scale: 1:300 @ A2

© 2017 Copyright of Conrad Energy Link. All Rights Reserved.

Do not scale from this drawing

THE INFORMATION IN THIS DOCUMENT IS THE PROPERTY OF CONRAD ENERGY LINK. IT IS CONFIDENTIAL AND NOT BE LOANED, REPRODUCED, COPIED, OR DISCLOSED TO ANY OTHER PARTY WITHOUT THE WRITTEN PERMISSION OF CONRAD ENERGY LINK. CONRAD ENERGY LINK IS NOT RESPONSIBLE FOR ANY DAMAGE TO PROPERTY OR PERSONS ARISING FROM THE USE OF THIS INFORMATION.

© 2017 Copyright of Conrad Energy Link. All Rights Reserved.

Project Number: N/A  
 Project Title: Planning  
 Client: Conrad Energy  
 Project Start Date: 14.04.2019  
 Designer: AS  
 Checked By: AS  
 Approved By: AS  
 Drawing Number: PMG-PSP-03  
 Drawing Name: Main Layout Update 1

Sheet Title Stamp:  
 Scale: As Shown  
 Paper Size: A2  
 Drawing Status: PLANNING















